

Product: VIBRATORY COMPACTOR

Model: CB-335E VIBRATORY COMPACTOR C5F

Configuration: CB-334E,CB-335E Vibratory Compactor C5F00001-UP (MACHINE) POWERED BY 3024C Engine

## Disassembly and Assembly 3024C Engine for Caterpillar Built Machines

Media Number -SEN5006-04

Publication Date -01/01/2009

Date Updated -16/01/2009

i02234874

# Flywheel Housing - Remove and Install

SMCS - 1157-010

## Removal Procedure (Engines with Flywheel Housing and Back plate)

Table 1

Required Tools			
Tool	Part Number	Part Description	Qty
A	138-7573	Link Bracket	1

### Start By:

- Remove the flywheel. Refer to Disassembly and Assembly, "Flywheel - Remove".

---

### NOTICE

**Keep all parts clean from contaminants.**

**Contaminants may cause rapid wear and shortened component life.**

---

- Support the engine with a suitable lifting device or support the engine on blocks that are positioned on a flat level surface.
  - Install tool (A) and a suitable lifting device to the flywheel housing. Support the weight of the housing (8).
-

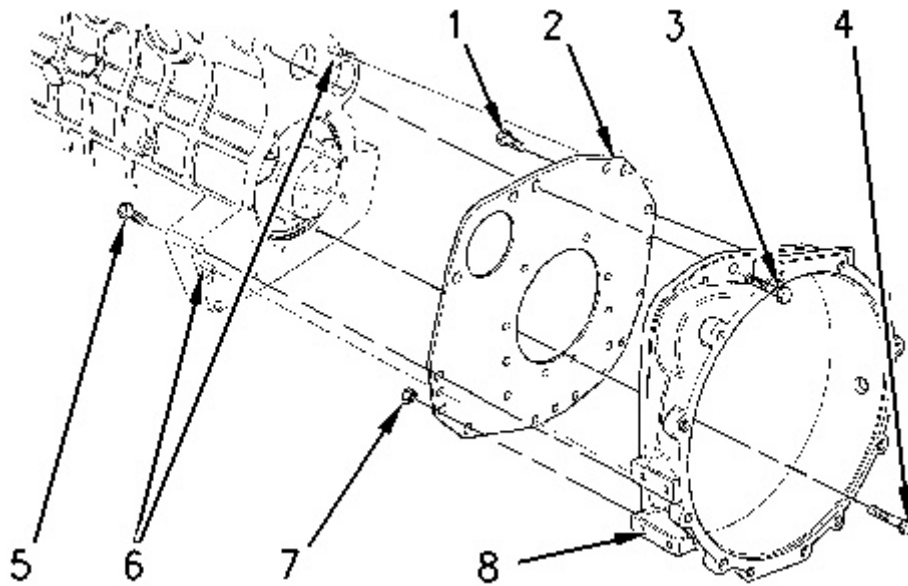

---

Illustration 1  
Typical example

g00827061

3. Remove the setscrews (3) that fasten the flywheel housing (8) to the cylinder block.
  4. Remove the setscrews (5) on each side of the cylinder block. These setscrews fasten the flywheel housing (8) to the cylinder block.
  5. Remove the setscrews (1) that fasten the back plate (2) to the flywheel housing (8).
  6. Remove the nuts (7) and the bolts (not shown) that fasten the back plate (2) to the flywheel housing (8).
-

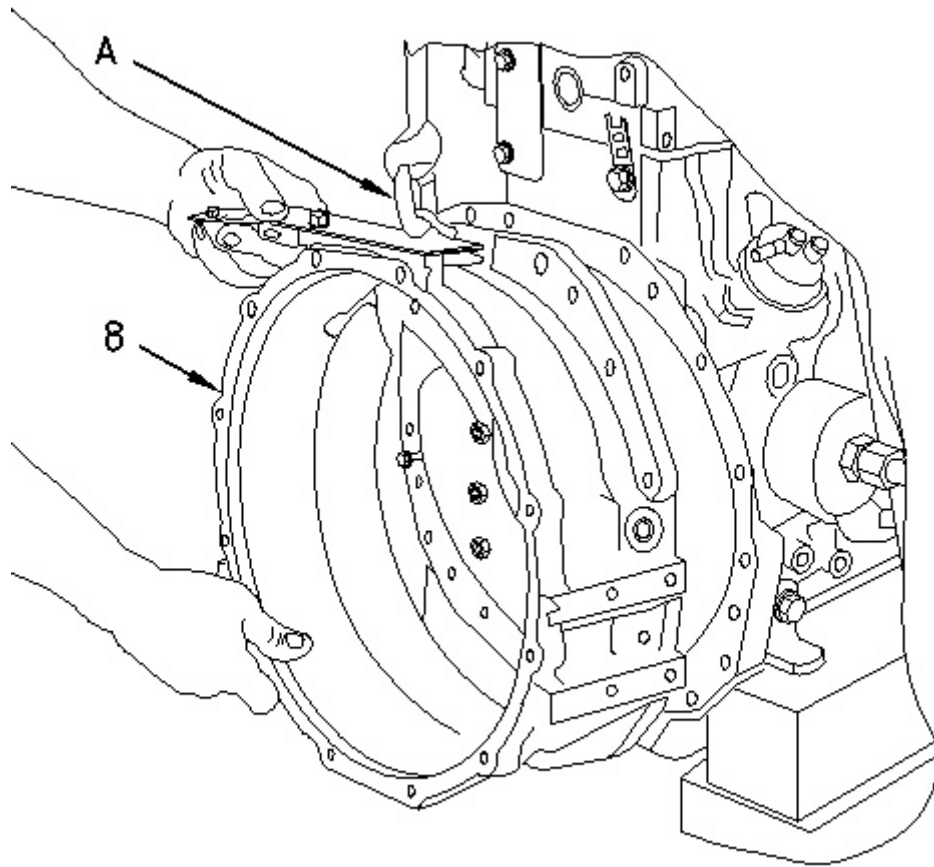

Illustration 2  
Typical example

g00826988

7. Use tool (A) and the lifting device to remove the flywheel housing (8) from the back plate.

## Removal Procedure (Engines with Flywheel Housing)

Table 2

Required Tools			
Tool	Part Number	Part Description	Qty
A	138-7573	Link Bracket	1

### Start By:

- a. Remove the flywheel. Refer to Disassembly and Assembly, "Flywheel - Remove".

---

### NOTICE

**Keep all parts clean from contaminants.**

**Contaminants may cause rapid wear and shortened component life.**

---

**Note:** The two cylinder, the three cylinder and the four cylinder engines have different flywheel housings. The removal procedure is similar for all models.

1. Support the engine with a suitable lifting device or support the engine on blocks that are positioned on a flat level surface.
2. Install tool (A) and a suitable lifting device to the flywheel housing. Support the weight of the housing (2).

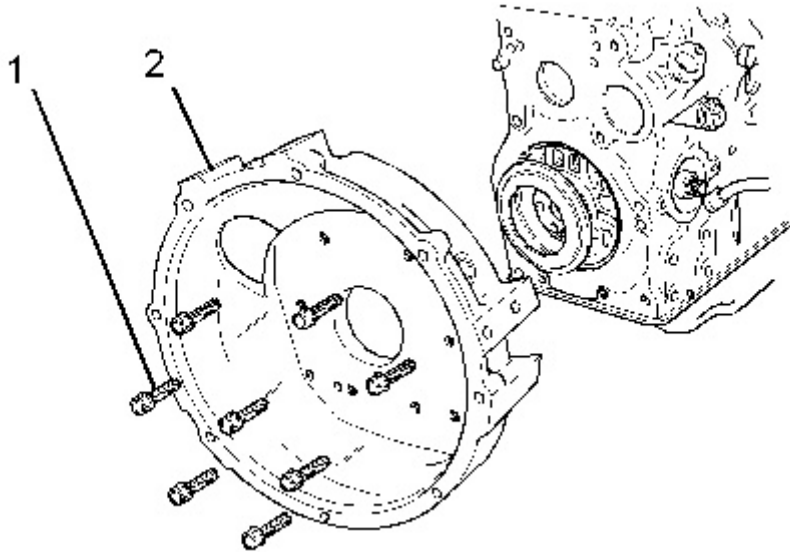

Illustration 3

g01123577

Typical example

3. Remove the setscrews (1) that fasten the flywheel housing (2) to the cylinder block.
-

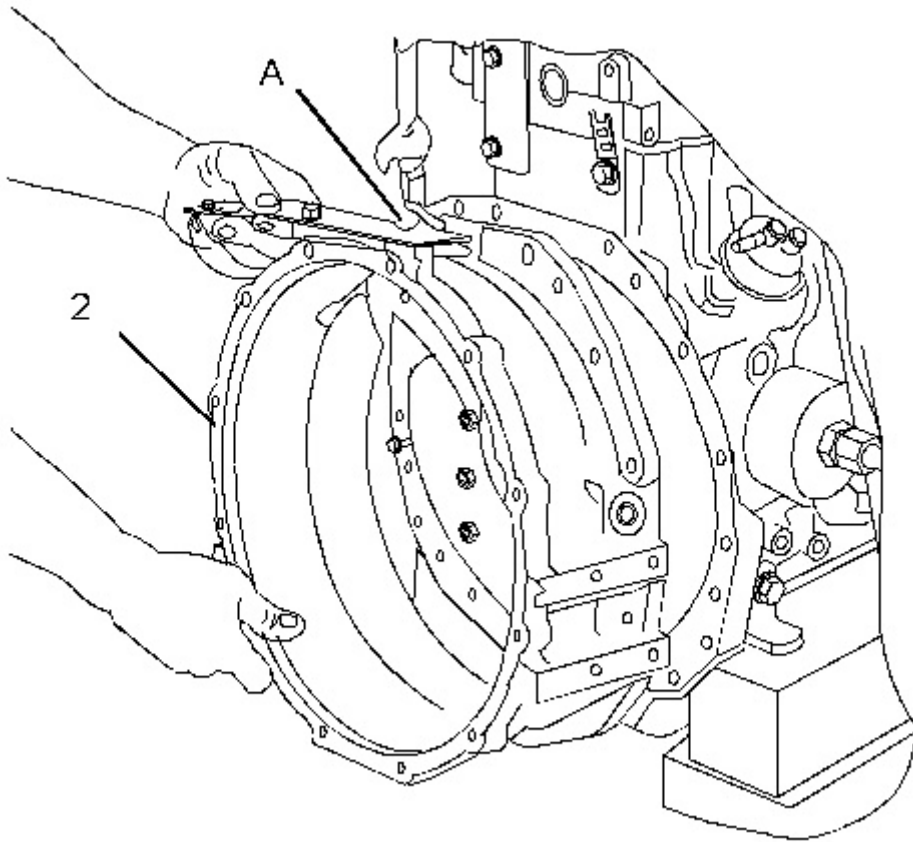

Illustration 4

g01126979

4. Use the tool (A) and the lifting device to remove the flywheel housing (2) from the engine.

## Installation Procedure (Engines with Flywheel Housing and Back plate)

Table 3

Required Tools			
Tool	Part Number	Part Description	Qty
A	138-7573	Link Bracket	1

### NOTICE

**Keep all parts clean from contaminants.**

**Contaminants may cause rapid wear and shortened component life.**

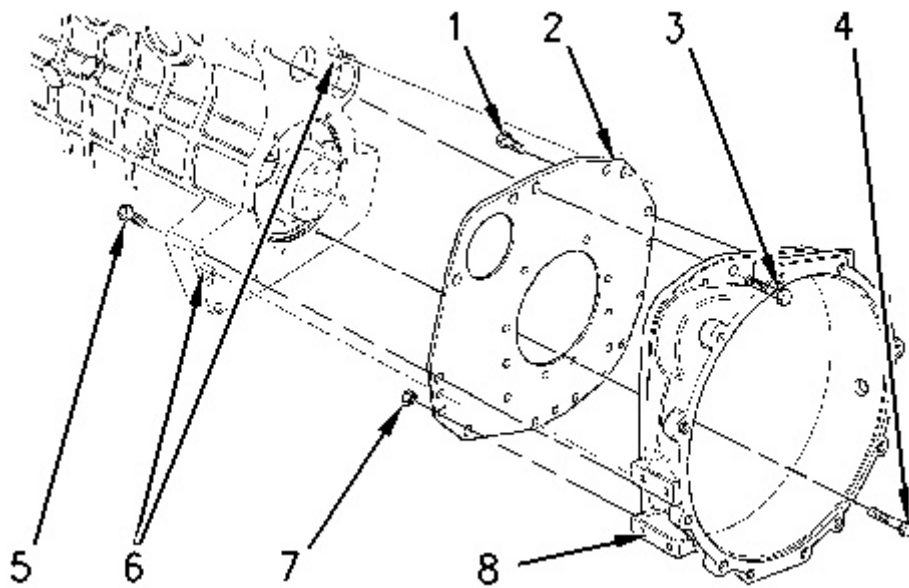
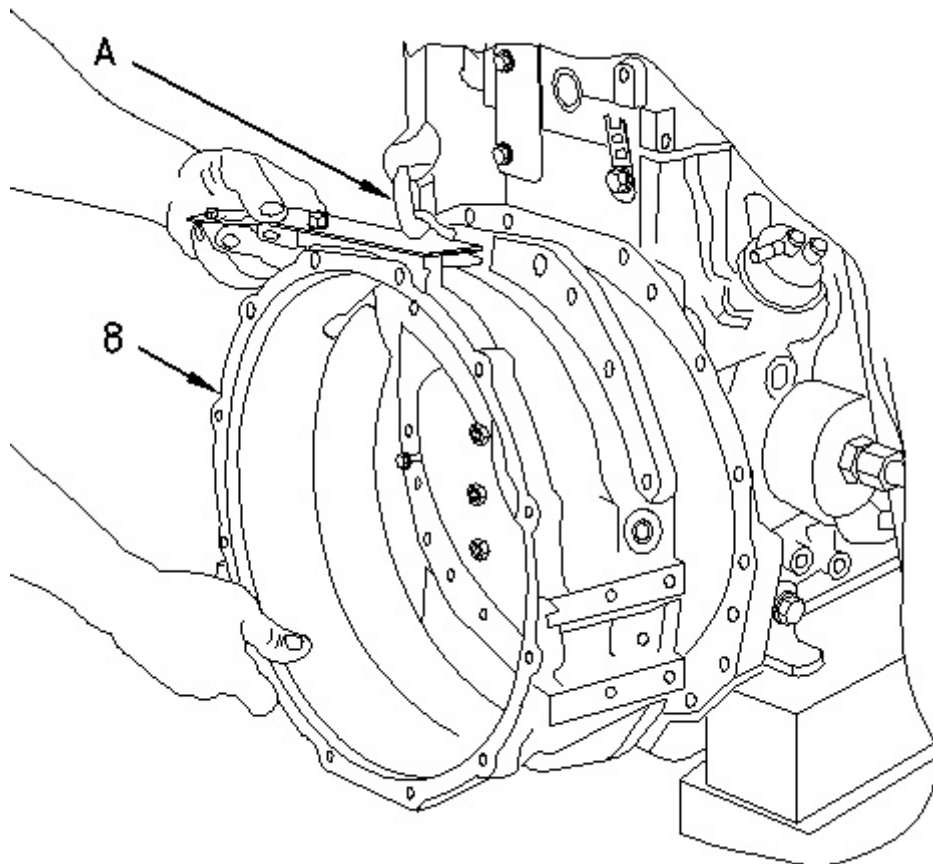

Illustration 5  
Typical example

g00827061

1. Clean the rear face of the back plate (2) and the faces of the flywheel housing (8). Inspect the crankshaft rear seal (not shown) for leaks. Inspect the dowels (6) for damage. If the crankshaft rear seal or the dowels are damaged, use new parts for replacement. Refer to Disassembly and Assembly, "Crankshaft Rear Seal - Remove" and Disassembly and Assembly, "Crankshaft Rear Seal - Install".



2. Use tool (A) and the lifting device to align the flywheel housing (8) to the dowels (6). Install the flywheel housing to the back plate.
3. Install the nuts (7) and the bolts (not shown) that fasten the back plate (2) to the flywheel housing (8).
4. Install the setscrews (1) that fasten the back plate (2) to the flywheel housing (8).
5. Install the setscrews (5) on each side of the cylinder block. These setscrews fasten the flywheel housing (8) to the cylinder block.
6. Remove the tool (A) and the lifting device from the flywheel housing.
7. Install the setscrews (3) that fasten the flywheel housing (8) to the cylinder block.
8. For C1.5/3013C, C2.2/3024C and C2.2/3024CT engines, tighten the fasteners to a torque of 25 N·m (19 lb ft).

**End By:**

- a. Install the flywheel. Refer to Disassembly and Assembly, "Flywheel - Install".

## Installation Procedure (Engines with Flywheel Housing)

Table 4

<b>Required Tools</b>			
<b>Tool</b>	<b>Part Number</b>	<b>Part Description</b>	<b>Qty</b>
A	138-7573	Link Bracket	1

---

### NOTICE

**Keep all parts clean from contaminants.**

**Contaminants may cause rapid wear and shortened component life.**

---



---

Thank you so much for reading.  
Please click the “Buy Now!”  
button below to download the  
complete manual.



After you pay.

You can download the most  
perfect and complete manual in  
the world immediately.

Our support email:

[ebooklibonline@outlook.com](mailto:ebooklibonline@outlook.com)