



Service Repair Manual

Models

312C and 312C L Excavator

Product: EXCAVATOR
Model: 312C L EXCAVATOR CBA
Configuration: 312C & 312C L Excavators CBA00001-01200 (MACHINE)

Disassembly and Assembly 3064 and 3066 Engines for Caterpillar Built Machines

Media Number -SEN5553-10

Publication Date -01/05/2012

Date Updated -15/05/2012

i01615293

Engine Oil Bypass Valve - Remove and Install

SMCS - 1306-010-BV

Removal Procedure

Start By:

- A. Remove the engine oil pan. Refer to Disassembly and Assembly, "Engine Oil Pan - Remove and Install".

NOTICE

Keep all parts clean from contaminants.

Contaminants may cause rapid wear and shortened component life.

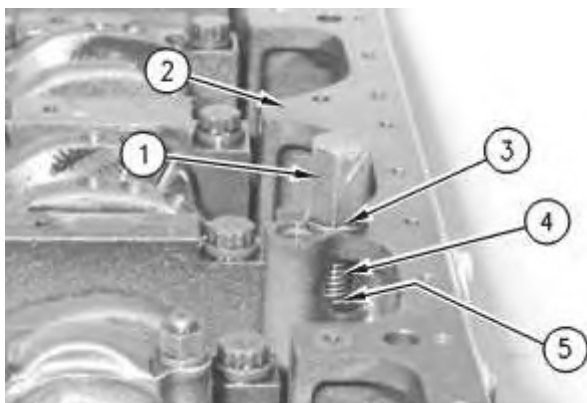

Illustration 1

g00607679

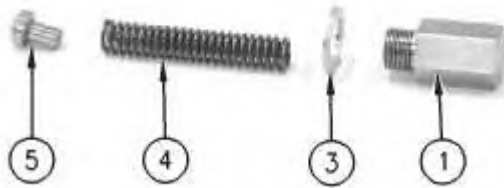

Illustration 2

g00607688

1. Remove threaded plug (1) for the engine oil bypass valve from the cylinder block (2) .
2. Remove shim (3) from the cylinder block (2) .
3. Remove spring (4) from the cylinder block (2) .
4. Remove spring seat (5) from the cylinder block (2) .

Note: Check the spring seat (5) and the valve seat for an abnormal contact pattern. Inspect the spring (4) for weakness or damage. If necessary, replace the engine oil bypass valve with a new part.

Note: Check the cylinder block (2) for oil passages that are clogged.

Installation Procedure

NOTICE

Keep all parts clean from contaminants.

Contaminants may cause rapid wear and shortened component life.

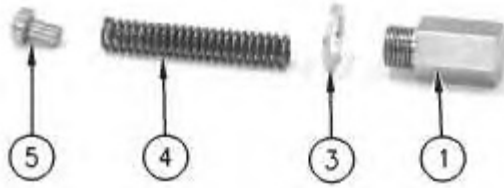

Illustration 3

g00607688

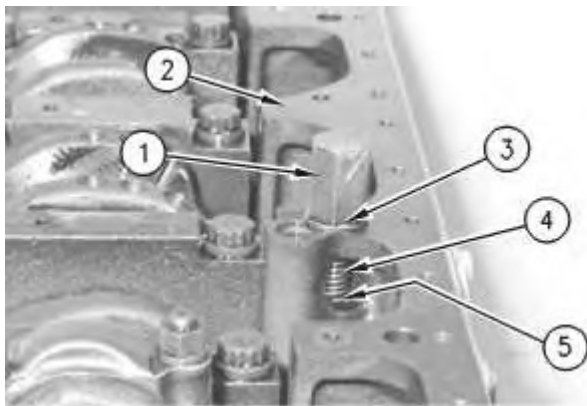

Illustration 4

g00607679

1. Install spring seat (5) (not shown) and spring (4) in the cylinder block (2) .
2. Install shim (3) and threaded plug (1) in the cylinder block (2) .
3. Tighten the threaded plug (1) to a torque of 69 ± 5 N·m (51 ± 4 lb ft).

Note: Test the opening pressure for the engine oil relief valve. The opening pressure for the relief valve is 981 ± 98 kPa (142 ± 14 psi). Make adjustments by shimming, if necessary.

For information on testing the engine oil relief valve, refer to Testing and Adjusting, "Lubrication System".

For more information, refer to Specifications, "Engine Oil Bypass Valve".

End By: Install the engine oil pan. Refer to Disassembly and Assembly, "Engine Oil Pan - Remove and Install".

Product: EXCAVATOR
Model: 312C L EXCAVATOR CBA
Configuration: 312C & 312C L Excavators CBA00001-01200 (MACHINE)

Disassembly and Assembly 3064 and 3066 Engines for Caterpillar Built Machines

Media Number -SEN5553-10

Publication Date -01/05/2012

Date Updated -15/05/2012

i01146335

Engine Oil Pump - Remove

SMCS - 1304-011

Removal Procedure

Table 1

Required Tools			
Tool	Part Number	Part Description	Qty
A	1P-2320	Combination Puller	1
B	1P-0510	Driver Group	1

Start By:

- A. Remove the front housing. Refer to Disassembly and Assembly, "Housing (Front) - Remove".

NOTICE

Keep all parts clean from contaminants.

Contaminants may cause rapid wear and shortened component life.

NOTICE

Care must be taken to ensure that fluids are contained during performance of inspection, maintenance, testing, adjusting and repair of the product. Be prepared to collect the fluid with suitable containers

Thank you so much for reading.
Please click the “Buy Now!”
button below to download the
complete manual.



After you pay.

You can download the most
perfect and complete manual in
the world immediately.

Our support email:

ebooklibonline@outlook.com