

Illustration 19

g00735215

20. Place inner cover housing (99) into position. Install allen head screw (107) in order to secure the inner cover housing in place.

Tighten the allen head screws to the following torque: $8 \pm 1.5 \text{ N}\cdot\text{m}$ ($71 \pm 13 \text{ lb in}$)

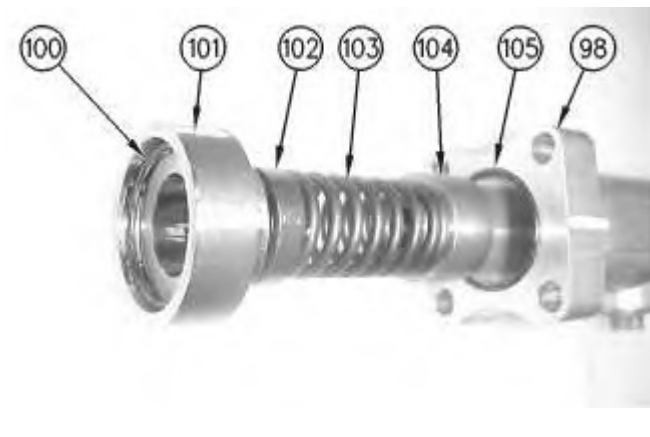
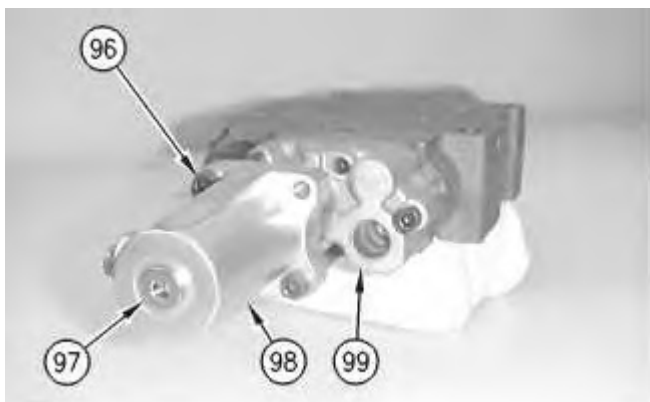

Illustration 20

g00736169

21. Install the following items in outer cover (98) : O-ring (105), cap (104), spring (103), plunger (102), spacer (101) and O-ring (100) .



22. Position outer cover (98) in place. Then install allen head screws (96) in order to secure outer cover (98) in place on inner cover housing (99) .

Tighten the allen head screws to the following torque: $8 \pm 1.5 \text{ N}\cdot\text{m}$ ($71 \pm 13 \text{ lb in}$)

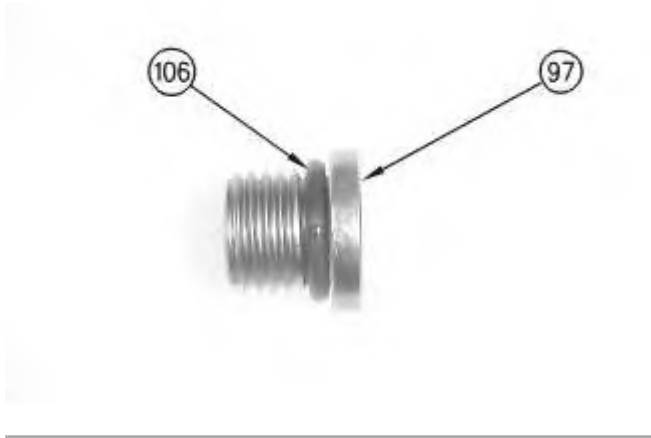

Illustration 22

g00735030

23. Install O-ring (106) onto plug (97) .
24. Install plug (97) into the outer cover.

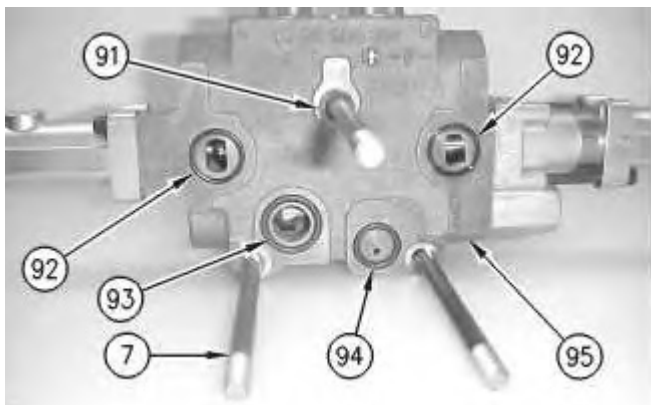

Illustration 23

g00733258

25. Install four O-rings in position on lift valve group (95) :
 - Two O-rings (92)
 - One O-ring (93)
 - One O-ring (94)

26. Carefully slide lift valve group (95) onto the studs. Then install shims (91) onto studs (7) .

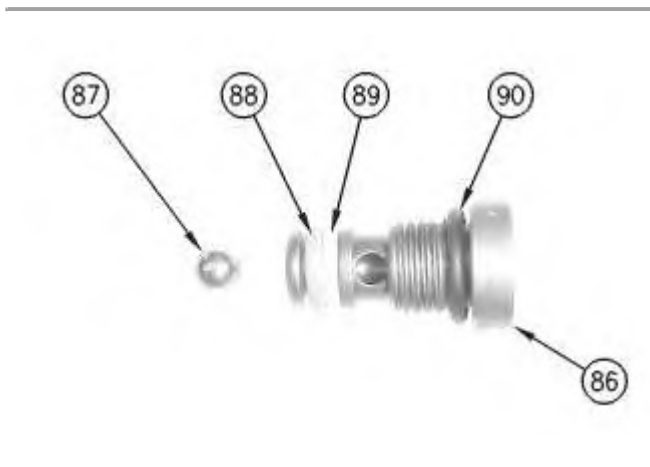

Illustration 24

g00734831

27. Install the following items onto seat (86) : check ball (87), O-ring (88), seal (89) and O-ring (90) .

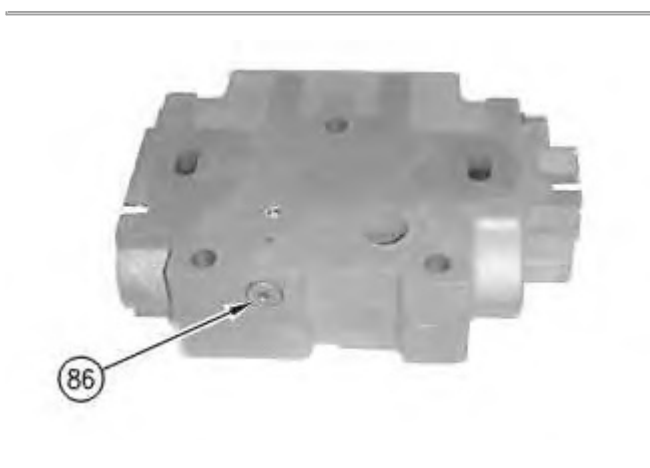

Illustration 25

g00734823

28. Install seat (86). Tighten the seat to the following torque: $14 \pm 2 \text{ N}\cdot\text{m}$ ($10 \pm 1 \text{ lb ft}$)

**Thank you very much
for your reading.**

**Please click here to buy
After you pay.**

**Then, you can
download the complete
manual instantly.
No waiting.**