

Product: ARTICULATED TRUCK

Model: 740 GC ARTICULATED TRUCK 3T8

Configuration: 740 Articulated Truck 3T800001-UP (MACHINE) POWERED BY C15 Engine

Disassembly and Assembly 740 GC, 740 Ejector, 745 Articulated Truck Machine System

Media Number -M0082510-04

Publication Date -01/09/2015

Date Updated -23/08/2018

i06248004

Gear Pump (Hydraulic Fan) - Assemble

SMCS - 1387-016-GT; 5073-016-HFN

Assembly Procedure

Table 1

Required Tools			
Tool	Part Number	Part Description	Qty
A	1P-1857	Retaining Ring Pliers	1
B	1P-0510	Driver Gp	1

1. On assembly, lubricate all internal components with the lubricant that is being sealed.

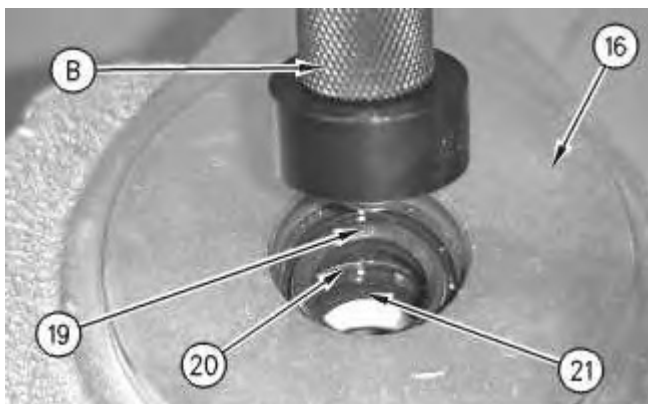

Illustration 1

g00802426

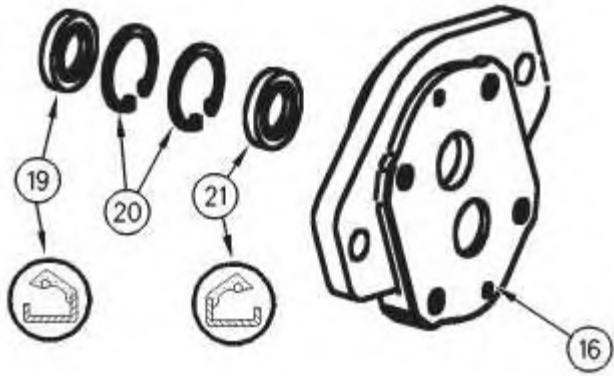

Illustration 2

g00802435

2. Use tool (B) to install lip seal (21) with the lip of the seal toward flange (16). Use tool (A) to install two retaining rings (20) into the ring grooves in flange (16). Use tool (B) to install lip seal (19) with the lip of the seal away from flange (16).

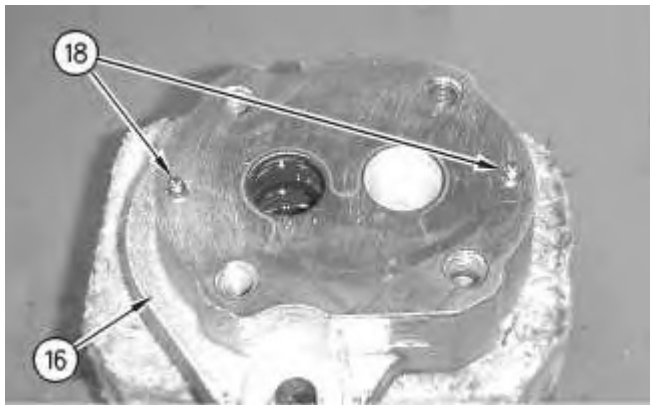

Illustration 3

g00802465

3. Install two dowels (18) into flange (16).

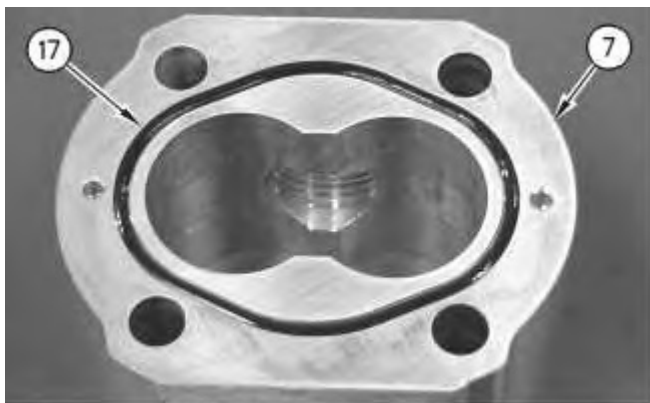

Illustration 4

g00802357

4. Install seal (17) into housing (7).



Illustration 5

g00802352

5. Align housing (7) with the dowel in flange (16) and position the housing on the flange.

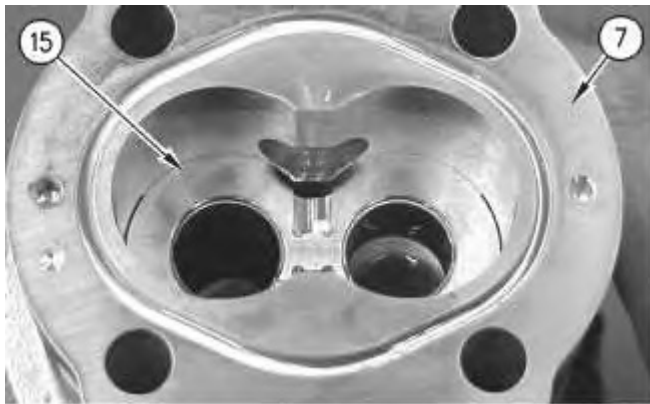

Illustration 6

g00802350

6. Install pressure plate (15) into housing (7). Refer to step 8 for the installation of the seals.

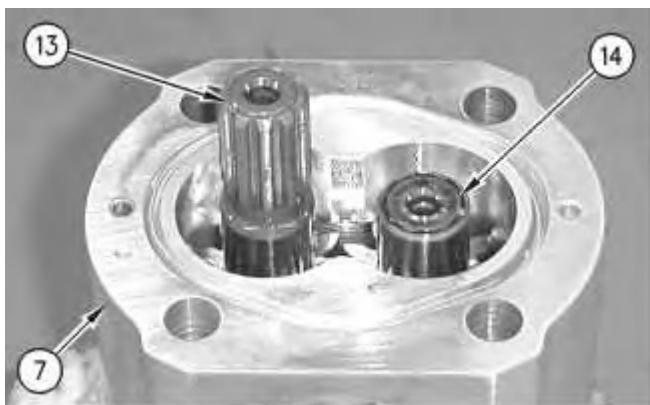

Illustration 7

g00802349

7. Install idler gear (14) and gear shaft (13) into housing (7).

**Thank you very much
for your reading.**

**Please click here to buy
After you pay.**

**Then, you can
download the complete
manual instantly.
No waiting.**