

Product: BACKHOE LOADER

Model: 430F2 BACKHOE LOADER HWE

Configuration: 430F2 Center Pivot Backhoe Loader HWE00001-UP (MACHINE) POWERED BY C4.4 Engine

Disassembly and Assembly C4.4 Engines for Caterpillar Built Machines

Media Number -UENR4516-11

Publication Date -01/06/2015

Date Updated -29/10/2018

i05820280

Crankshaft Rear Seal - Install

SMCS - 1161-012

Installation Procedure

Table 1

Required Tools			
Tool	Part Number	Part Description	Qty
A	227-4390	E12 Torx Socket	1
B	FT-2806	Alignment Tool	1

Note: The crankshaft rear seal and the housing are manufactured as a one-piece assembly.

NOTICE

Keep all parts clean from contaminants.

Contaminants may cause rapid wear and shortened component life.

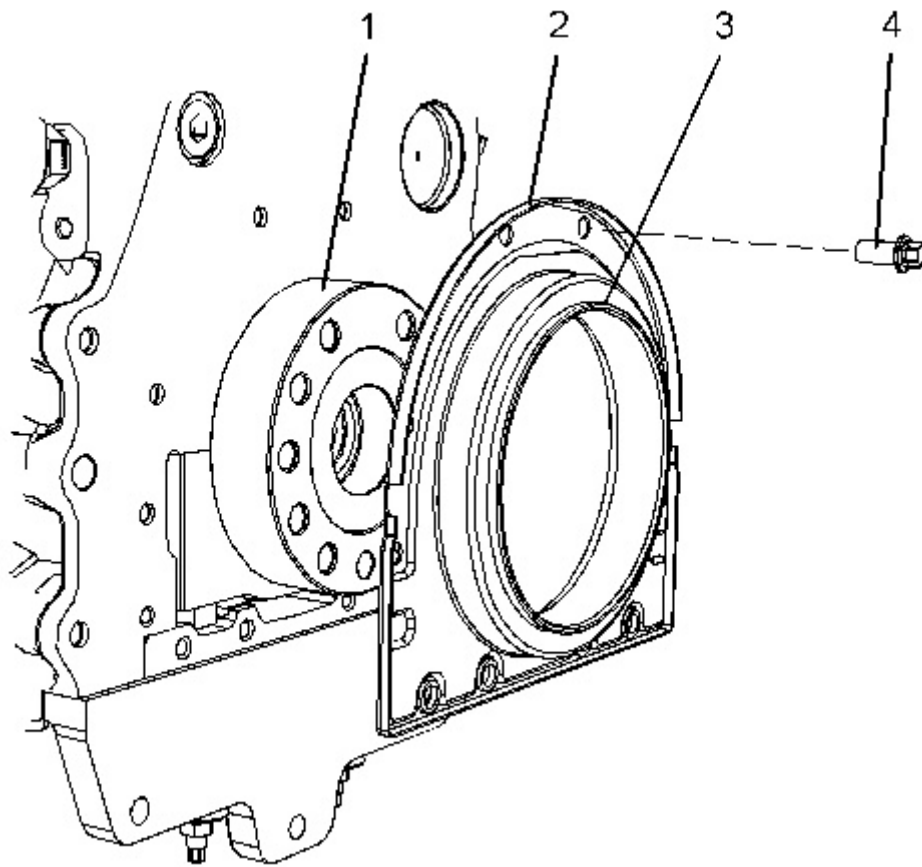

Illustration 1

g02450219

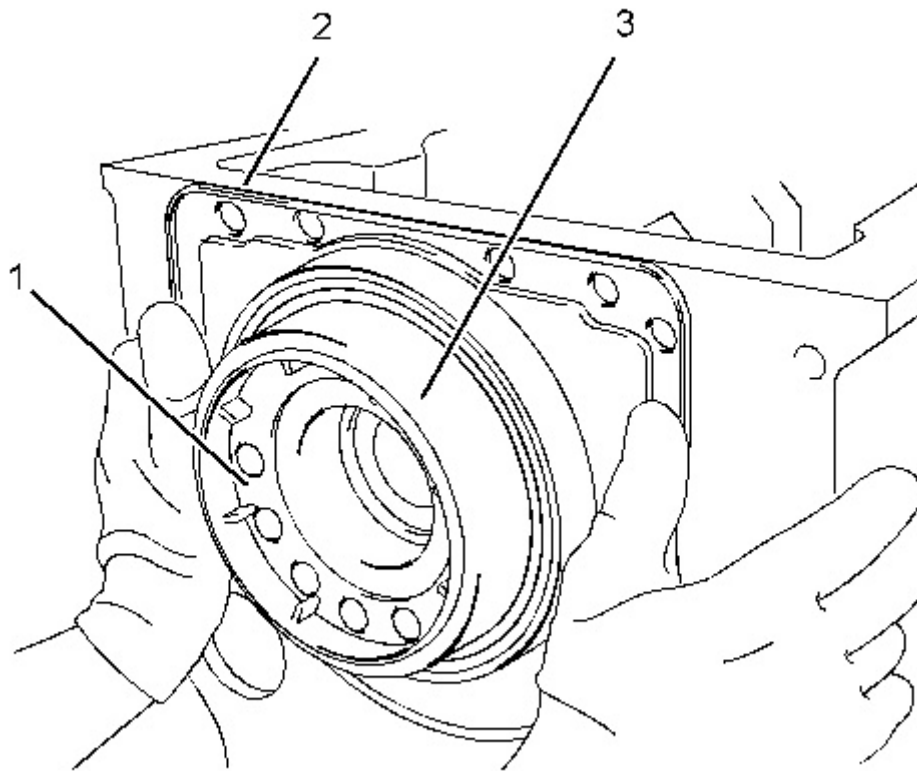

Illustration 2

g02450222

1. Ensure that crankshaft flange (1) is clean, dry, and free from damage.
2. Ensure that the face of the cylinder block and the bridge piece are clean and dry.
3. A new crankshaft rear seal is supplied with a plastic sleeve (3). Ensure that the plastic sleeve is squarely installed within crankshaft rear seal (2).

Note: The plastic sleeve is included in order to protect the lip of the seal as the seal is pushed over the crankshaft flange.

Note: Do not lubricate the crankshaft rear seal or the crankshaft flange. The crankshaft rear seal must be installed dry.

4. Align plastic sleeve (3) with crankshaft flange (1). Ensure that the plastic sleeve is engaged onto the crankshaft flange. Push new crankshaft rear seal (2) squarely onto the crankshaft flange.

During this process, the plastic sleeve will be forced out of the crankshaft rear seal. Discard the plastic sleeve.

5. Align the two molded locators on crankshaft rear seal (2) with the holes in the cylinder block. Ensure that the crankshaft rear seal is seated against the cylinder block.
-

**Thank you very much
for your reading.**

**Please click here to buy
After you pay.**

**Then, you can
download the complete
manual instantly.
No waiting.**