

Transmission case



Illustration 1

g03831934

1. Install breather (168).

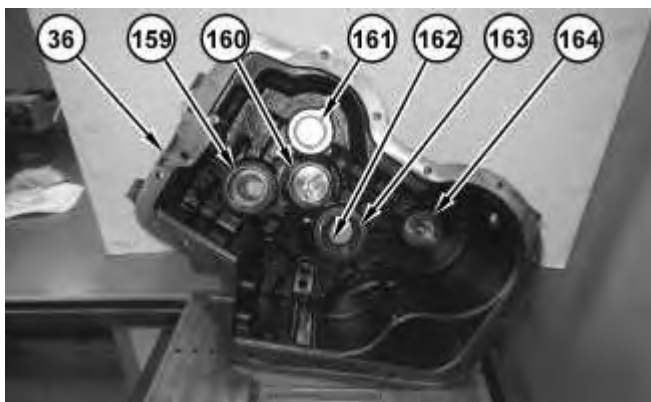

Illustration 2

g03831928

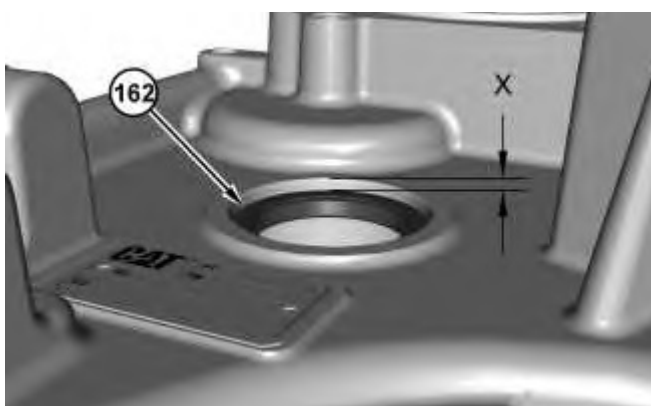

Illustration 3

g03832503

2. Use Tooling (J) to install lip seal (162) into case (36). Dimension (X) is the depth to install lip seal (162) into case (36). Dimension (X) is 4.00 ± 0.25 mm (0.157 ± 0.010 inch).

Note: Install the shims behind each bearing cup that was recorded on the disassembly procedure.

3. Install bearing cup (159), bearing cup (160), bearing cup (161), bearing cup (163), and bearing cup (164) into case (36).



Illustration 4

g03831925

4. Install temperature sensor (158). Tighten temperature sensor (158) to a torque of 20 ± 3 N·m (177 ± 27 lb in).

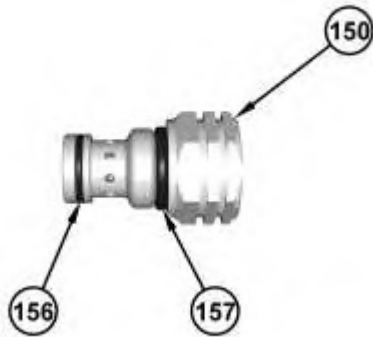
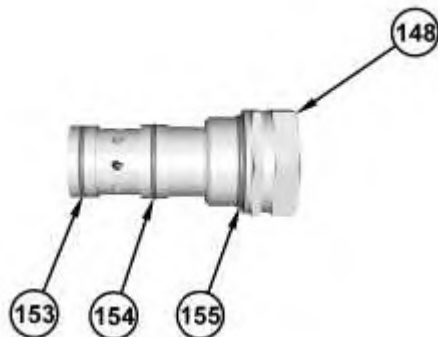

Illustration 5

g03831923

5. Install O-ring seals (156) and (157) onto relief valve (150).



6. Install O-ring seals (153), (154), and (155) onto relief valve (148).

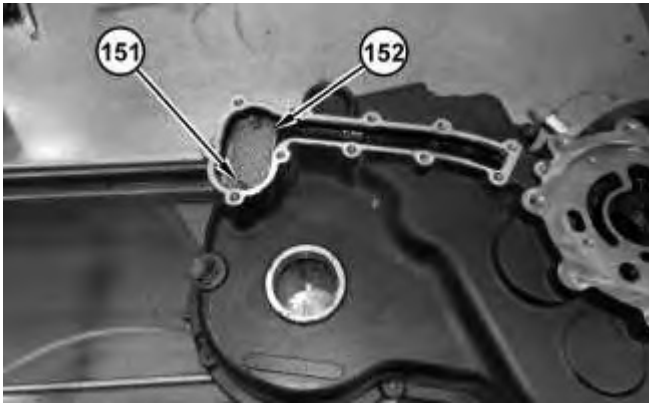

Illustration 7

7. Install strainer (152) and bolts (151).

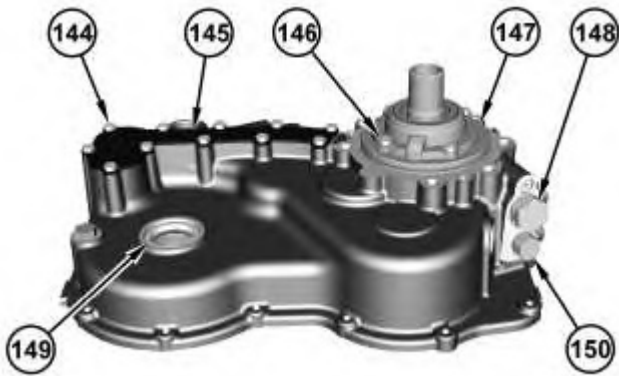

Illustration 8

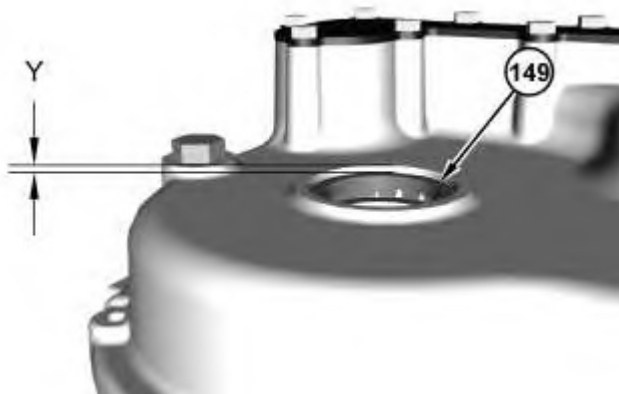

Illustration 9

8. Install relief valve (148). Tighten relief valve (148) to a torque 46 to 54 N·m (34 to 40 lb ft).

**Thank you very much
for your reading.**

**Please click here to buy
After you pay.**

**Then, you can
download the complete
manual instantly.
No waiting.**