

To prevent contaminants from entering the hydraulic system, always plug or cap the lines, fittings, or hoses as they are disconnected. Cover any disassembled components and clean them properly before assembly.

Clean the hydraulic system properly after any major component exchange or especially after a component failure, to remove any contamination.

Note: Cleanliness is an important factor. Before the disassembly procedure, the exterior of the component should be thoroughly cleaned. This will help to prevent dirt from entering the internal mechanism.

Note: Put identification marks on all of the components of the control valve bank as the components are being removed. All of the parts must be reinstalled in the part's original location. Do not damage any of the internal parts during the removal. Keep all of the internal parts of the valve clean and lubricated.

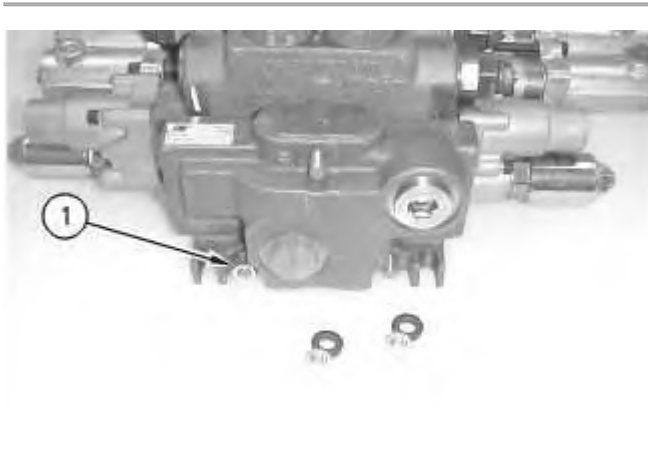

Illustration 1

g00733207

1. Remove nuts (1) and the washers.

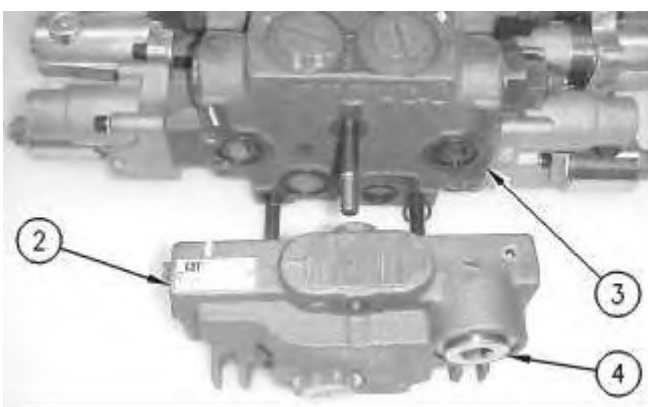

Illustration 2

g00733215

2. Separate cover (2) from auxiliary valve (3).

3. Remove plug (4).

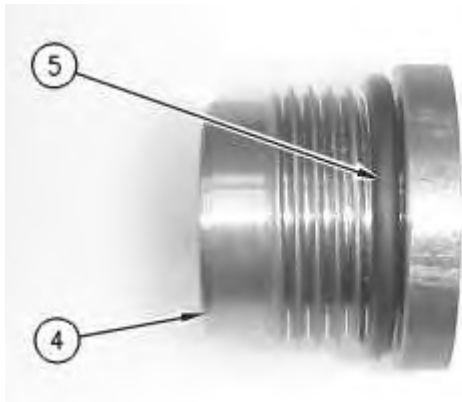

Illustration 3

g00733197

4. Remove O-ring seal (5) from plug (4).

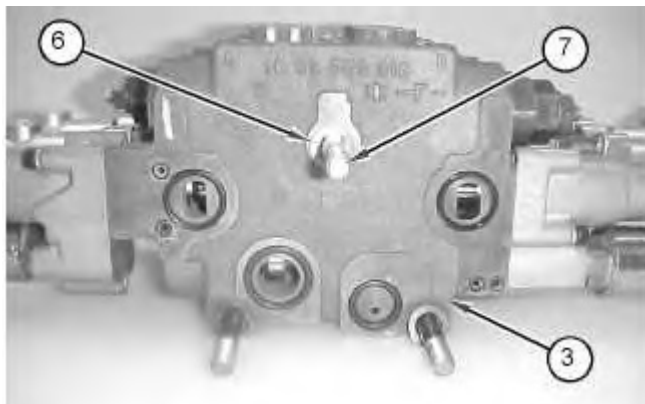
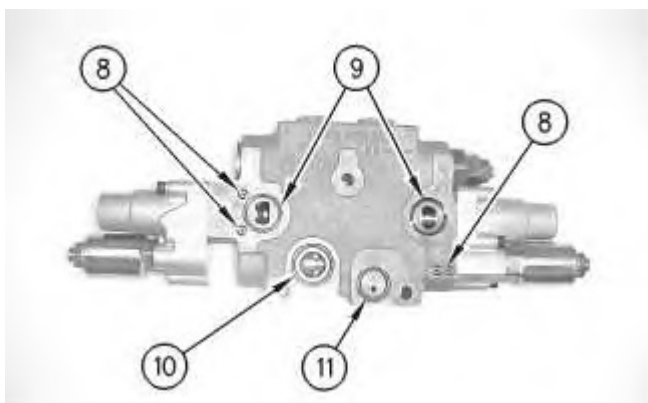

Illustration 4

g01085622

5. Remove shims (6) from studs (7).

6. Slide auxiliary valve (3) from studs (7).



- Remove O-ring seals (8), (9), (10), and (11) from the auxiliary valve.

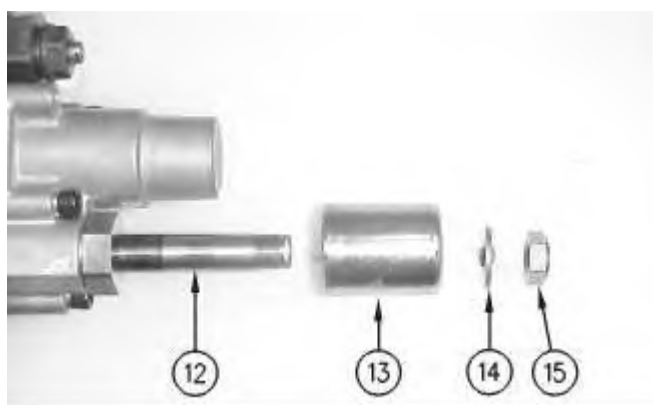

Illustration 6

- Remove the following items from cartridge assembly (12): nut (15), washer (14) and coil assembly (13).
- Remove cartridge assembly (12).

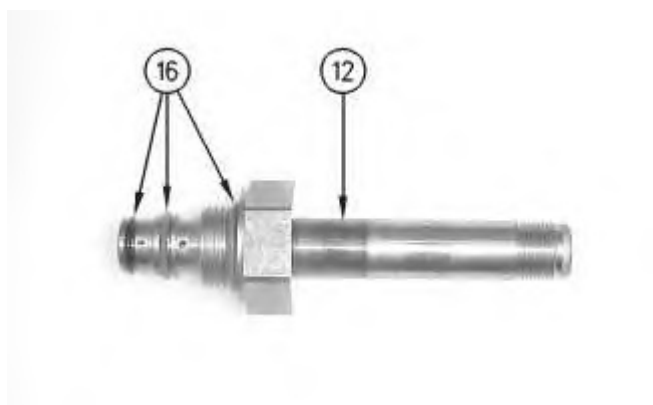

Illustration 7

- Remove O-ring seals (16) from cartridge assembly (12).



11. Remove allen head screws (17) and cover (18).

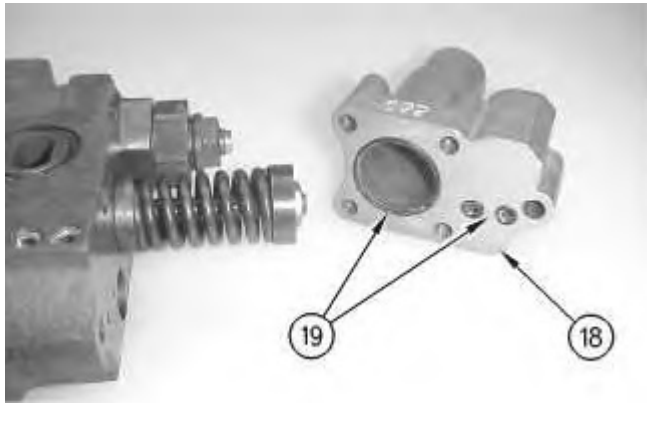

Illustration 9

12. Remove O-ring seals (19) from cover (18).
13. Repeat Steps 8 through 12 for the other cover.



Illustration 10

14. Remove valve group (20).



**Thank you very much
for your reading.**

**Please click here to buy
After you pay.**

**Then, you can
download the complete
manual instantly.
No waiting.**