

Product: EXCAVATOR

Model: 245 EXCAVATOR 94L

Configuration: 245 EXCAVATOR 94L00001-00254 (MACHINE) POWERED BY 3406 ENGINE

## Disassembly and Assembly 245 EXCAVATOR VEHICLE SYSTEMS

Media Number -SEN7339-02

Publication Date -01/01/1983

Date Updated -12/10/2001

### Speed And Direction Pilot Control Valve

SMCS - 5462-11; 5462-12; 5462-15; 5462-16

### Remove Speed And Direction Pilot Control Valve

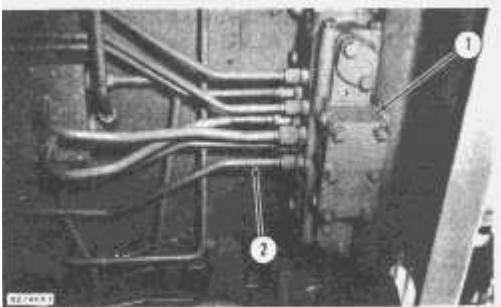

1. Disconnect the seven oil lines (2) from the control valve.

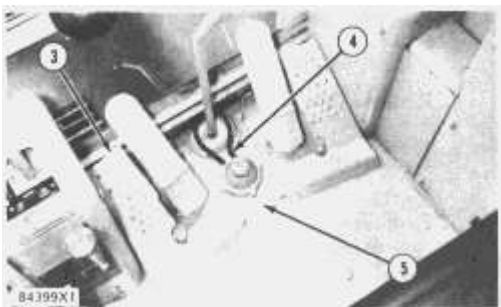

2. Disconnect the two hoses (4) from the foot control for the windshield washer.

3. Remove the two supports (3).

4. Remove the bolts (5) from bracket.

5. Remove the speed and direction pilot control valve (1) and the bracket as a unit. The weight of the unit is 70 lb. (32 kg).

### Install Speed And Direction Pilot Control Valve

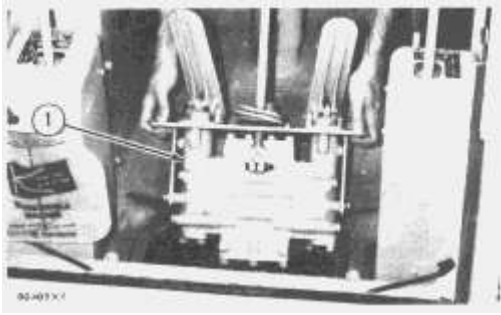

1. Put the bracket and speed and direction pilot control valve (1) in position. Install the bolts that hold the bracket in place.
2. Install the two foot supports.
3. Connect the two hoses to the foot control for the windshield washer.

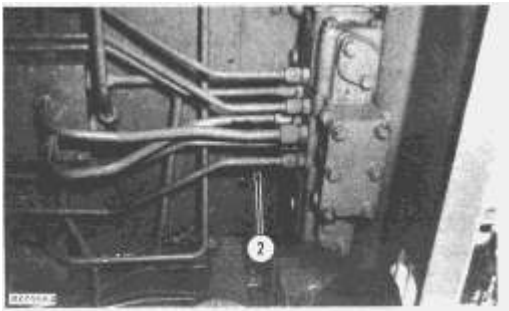

4. Connect the seven oil lines (2) to the speed and direction pilot control valve.

## Disassemble Speed And Direction Pilot Control Valve

start by:

- a) remove speed and direction pilot control valve.

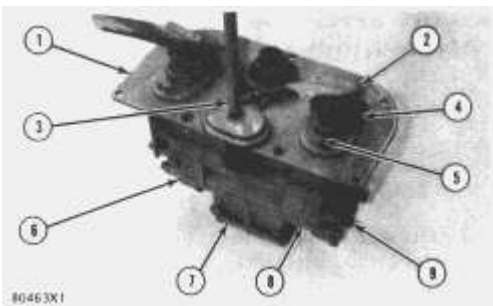

1. Remove the two foot pedals (2).
2. Remove the two bolts (5) from each support.
3. Remove the two supports (4) and two stems.
4. Remove the control lever (3).
5. Remove the four bolts (9) and bracket (1).

6. Remove the forward valve group (6) and reverse valve group (8) from steering valve group (7).
7. Remove the covers from valve groups (6) and (8).
8. Remove slug (13), spring (16), and valve stem (12) from valve bodies.

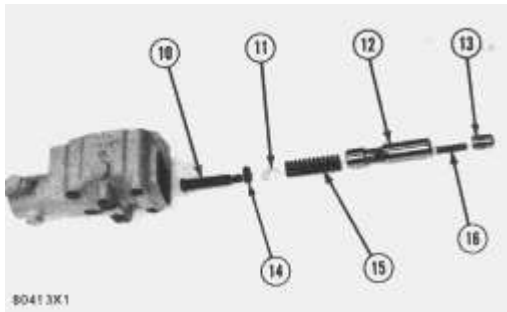

9. Remove bolt (10), retainer (14), shims (11), and spring (15) from valve stem. Keep shims for use during assembly of valve group. Remove the seal from valve bodies.

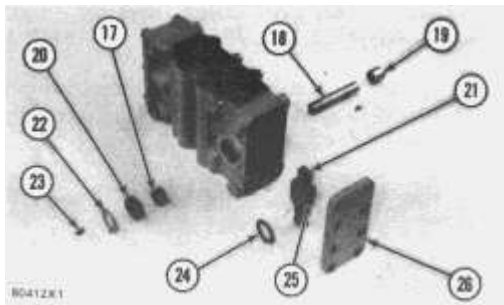

10. Remove cover (26) from body. Remove key (23) and washer (22) from shaft (18).
11. Loosen bolt (25), and remove bearing (19), shaft (18), lever (21), and washer (24).
12. Remove the seal (20) and bearing (17).

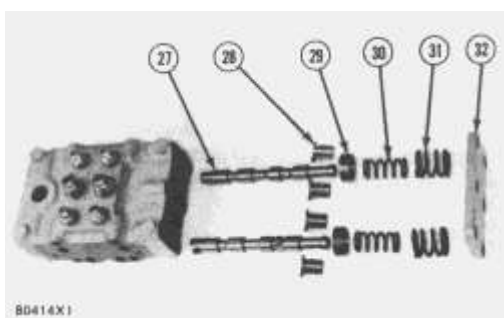

13. Remove the cover (32), springs (31) and (30), retainers (29) and (28), and valve stems (27). Put location marks on valve stems as to their location in valve body.

## Assemble Speed And Direction Pilot Control Valve

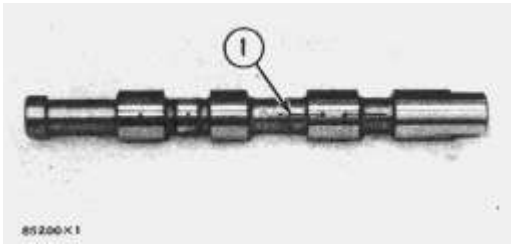

1. Put valve stems (15) and (16) in their respective positions in valve body with grooves (slots) (1) in stems toward the openings for the oil lines in valve body (29).
2. Install retainers (30) and (32), springs (34) and (31), and cover (33).

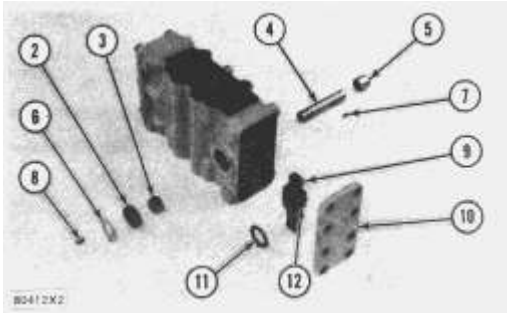

3. Install bearings (3) and (5). Install seal (2) in valve body with lip of the seal toward bearing (3).
  4. Install shaft (4), lever (9), washer (11), and key (7). Put lever in position on shaft and tighten bolt (12). Install cover (10).
- NOTE:** The grooves (slots) (1) in valve stems (15) and (16) must be visible (can be seen) through the openings for the oil lines in valve body (29) after installation of lever (9).
5. Install washer (6) and key (8) on the shaft.

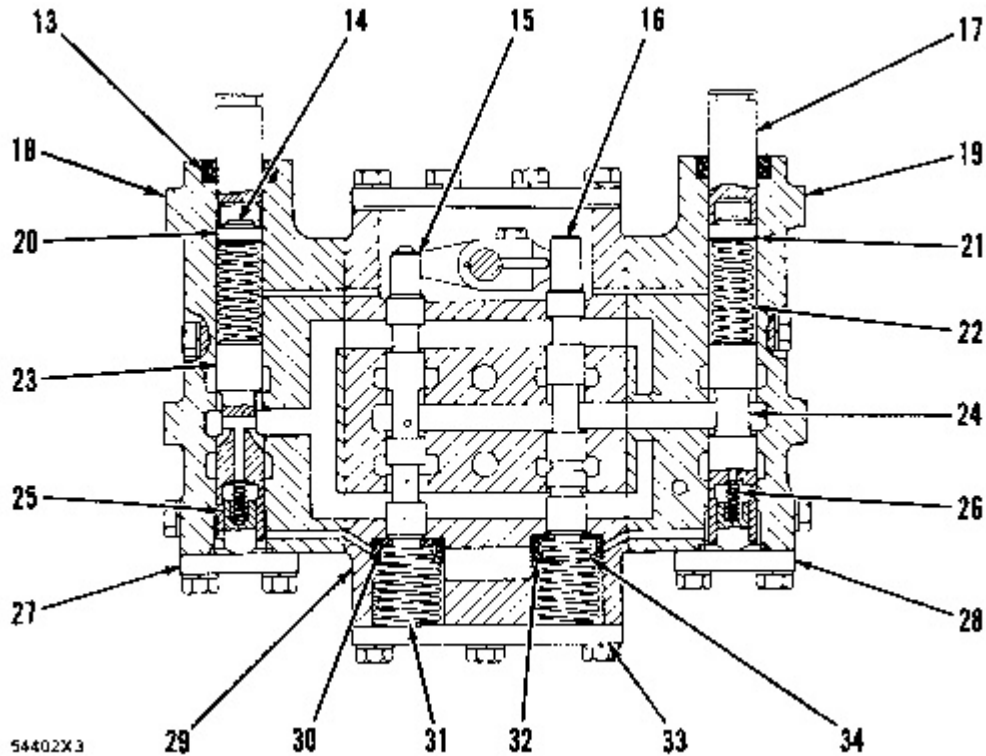

6. Install seals (13) with the lips of the seals toward the inside of the valve bodies.
7. Install springs (22), shims (21), retainers (20), and bolts (14) on stems (23) and (24).
8. Install valve stems (23) and (24), springs (26), and slugs (25) in valve bodies (18) and (19). Install covers (27) and (28).
9. Put valve bodies (18) and (19) in position on valve body (29), and install the bolts. Make sure O-ring seals are in place in valve bodies.

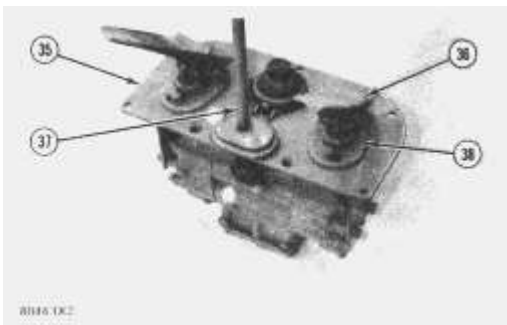

10. Install bracket (35) on control valve.
11. Install control lever (37).
12. Install stems (17), supports (38), and bolts.
13. Install the two foot pedals (36).

end by:

- a) install speed and direction pilot control valve

**Thank you very much  
for your reading.**

**Please click here to buy  
After you pay.**

**Then, you can  
download the complete  
manual instantly.  
No waiting.**