T2410, T2420 REPAIR MANUAL COMPLETE CONTENTS

SECTION 00 - GENERAL INFORMATION	2
SECTION 10 - ENGINE	3
SECTION 18 - CLUTCH	12
SECTION 21 - TRANSMISSION	13
SECTION 23 - FWD DRIVELINE	21
SECTION 25 - FWD FRONT AXLE	22
SECTION 27 - DIFFERENTIAL, REAR AXLE	23
SECTION 31 - POWER TAKE-OFF (PTO)	25
SECTION 33 - BRAKES	26
SECTION 35 - HYDRAULIC SYSTEM	27
SECTION 41 - STEERING	31
SECTION 44 - WHEELS AND TIRES	33
SECTION 50 - CLIMATE CONTROL	34
SECTION 55 - ELECTRICAL SYSTEM	38
SECTION 90 - PLATFORM	56

The following pages are the collation of the contents pages from each section and chapter of the T2410, T2420 Repair manual. Complete Repair part # 87725020.

The sections used through out all New Holland product Repair manuals may not be used for each product. Each Repair manual will be made up of one or several books. Each book will be labeled as to which sections are in the overall Repair manual and which sections are in each book.

The sections listed above are the sections utilized for the T2410, T2420 Tractors.

CYLINDER HEAD AND VALVE TRAIN COMPONENTS

The cylinder head incorporates the valve assemblies, rocker arms, rocker shaft, push rods, and lifters. A swirl chamber located between the injector assembly and the main combustion chamber of the cylinders provides improved starting and greater fuel efficiency. Initial combustion starts in the precombustion chamber and as the expansion occurs a strong swirl pattern is created in the main combustion chamber for more complete combustion of the air-fuel mixture. The air intake manifold is separate from the cast aluminum valve cover on all these engines. The exhaust manifold is bolted on the left-hand side of the cylinder head on each of the models. Cylinder heads have integral valve guides. Standard size valves only are used.

CYLINDER BLOCK ASSEMBLY

N844L-T

The cylinder block assembly contains the pistons, connecting rods, crankshaft, timing gears, and engine oil pump. The crankshaft is supported on five main bearings. The front bearing is positioned in a bore in front of the block. The other bearings are split liners located in holders bolted to the block. The camshaft is supported on four ball bearings located in the block.

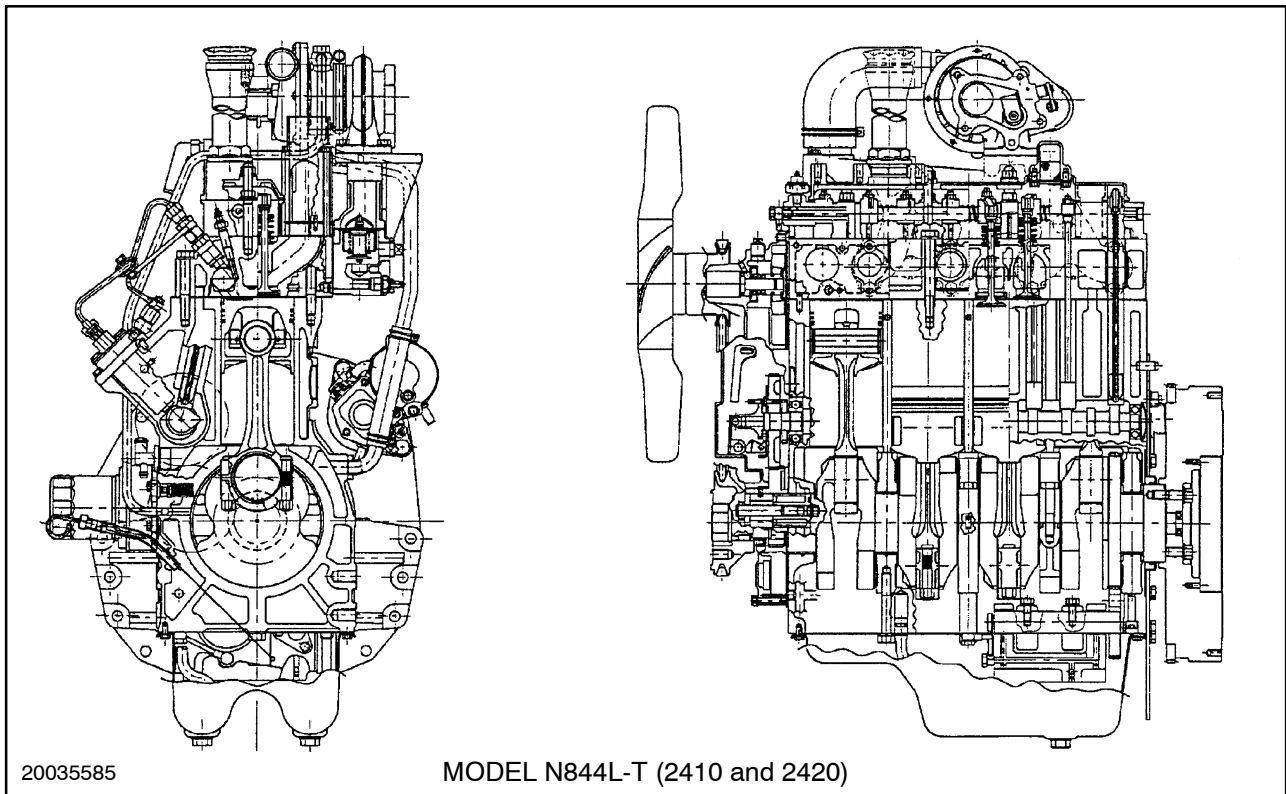

ENGINE

Removal

1. Disconnect the negative (-) battery cable, 1, and positive (+) battery cable, 2, from the battery.

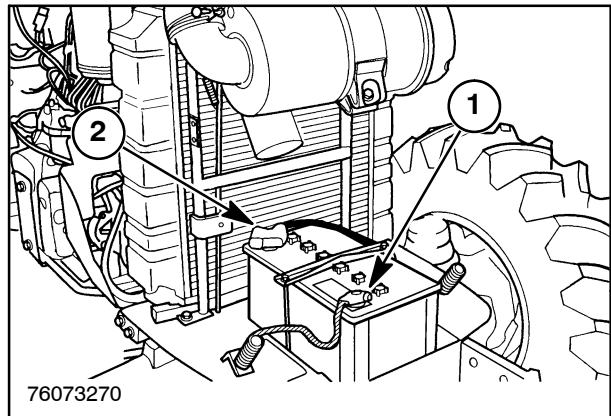

5

2. Disconnect the headlight wire harness plug, 1.
3. Remove the clips and pins, 2, from each side of the hood bracket.
4. Remove the support rod, 3, and remove the hood from the tractor.

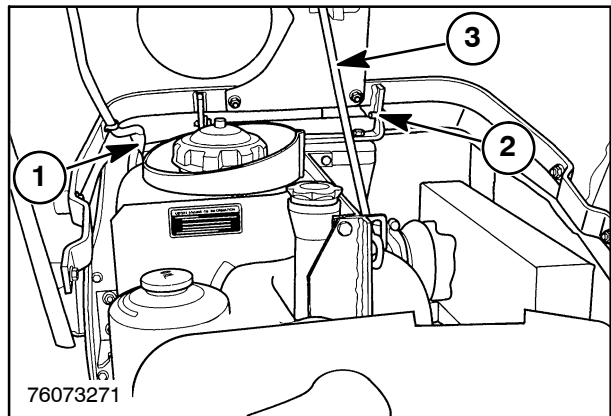

6

5. Drain the coolant from radiator, and engine using the petcock valve, 1. Remove radiator cap to assist draining.
6. Remove the radiator (see Radiator Removal in Section 10).

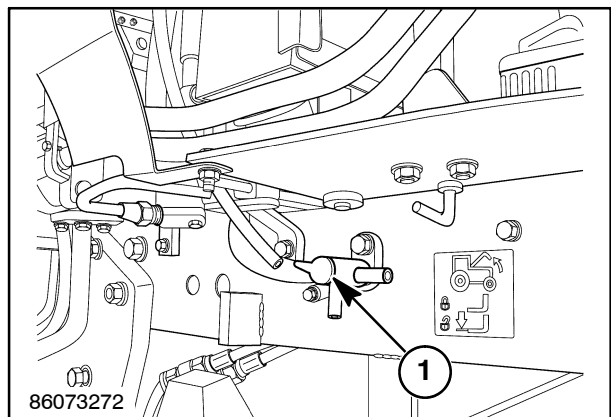

7

7. Loosen and remove the drain plug, 1, from the power steering reservoir, 2, and drain into a suitable container.

NOTE: See "Separating the Tractor at the Transmission" in Section 21 to separate the tractor.

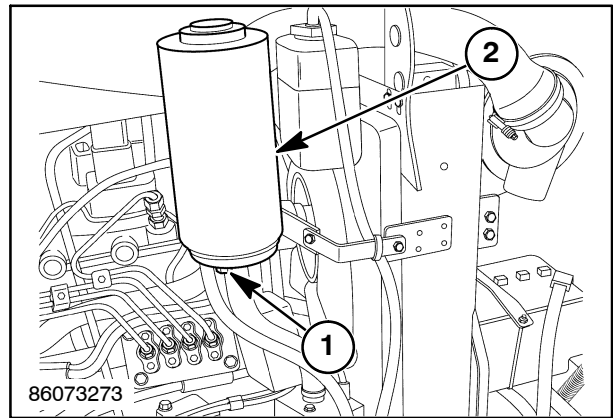

8

8. After the tractor has been successfully separated, support the front axle and the front support frame with jack stands.
9. Remove the firewall from the engine.
10. Remove the muffler and exhaust pipe from the tractor.
11. With the chain and hoist still attached to the engine, remove the mount bolts, 1, from each side of the frame rails.
12. Carefully remove the engine.

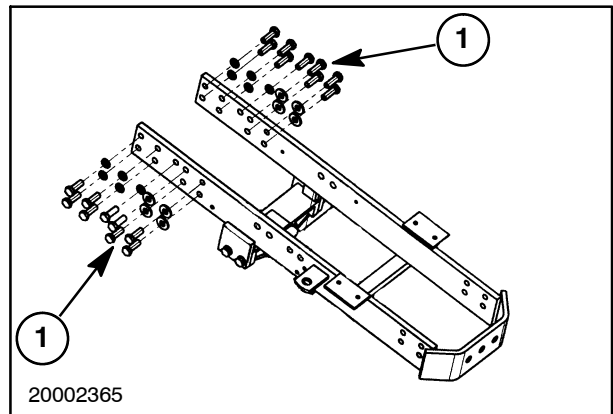

9

Installation

1. Attach a hoist to the engine, and position it onto the frame.
2. Install the engine mounting bolts on both sides of the frame. Apply Loctite® thread locker 242 to the thread of the bolts. Tighten bolts to the following torques:
 torques #1 - 80 N·m (60 ft-lbs)
 torques #2 - 80 N·m (60 ft-lbs)
 torques #3 - 175 N·m (130 ft-lbs)
3. Install the muffler and exhaust pipe onto the tractor.
4. Install the firewall onto the engine.

NOTE: See section 21 for attaching the engine to the transmission.

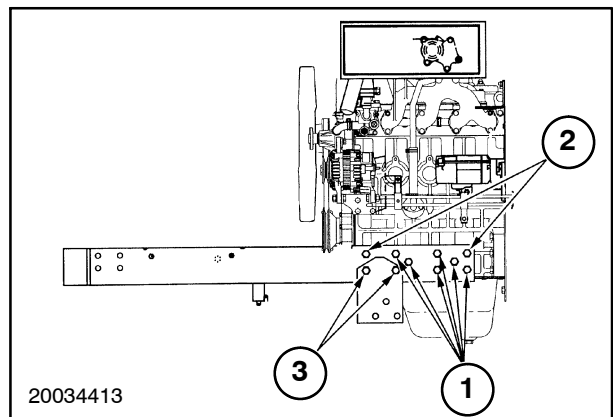

10

OVERHAUL

ENGINE

NOTE: Some procedures discussed in this chapter are shown with the engine in the tractor. Many of the procedures can be done with the engine in or out of the tractor.

ALTERNATOR

Removal

Disconnect the alternator wire harness and wires, 1.

Remove the alternator pivot and adjusting bracket, hardware, 2.

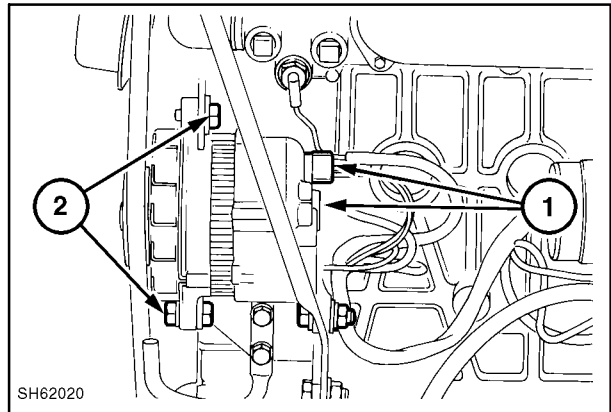

11

COOLING FAN AND PULLEY

Removal

Remove the fan, 1, retaining hardware and spacers.

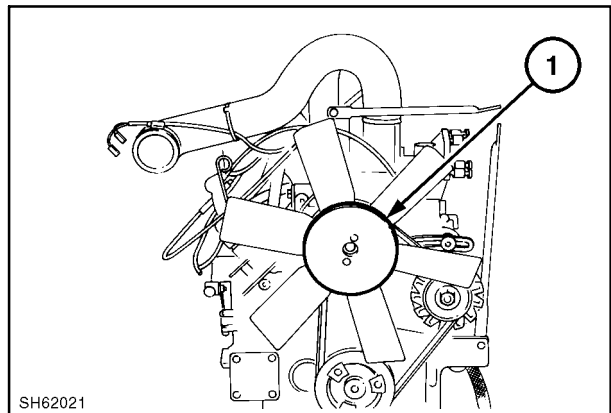

12

GLOW PLUG AND CONNECTOR

Removal

Remove the glow plugs, 1, and glow plug connectors, 2.

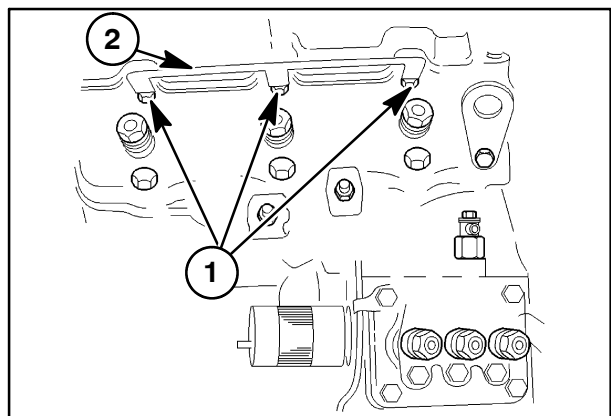

13

NOZZLE/HOLDER

Removal

Remove the nozzle and holder assembly with a socket for the nozzle holder.

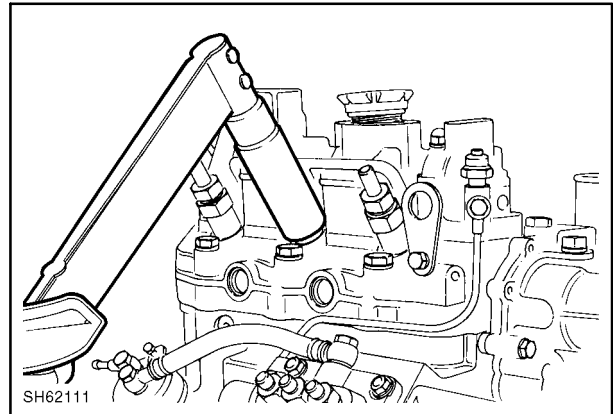

14

FUEL INJECTION PIPE

Removal

1. Loosen the fuel pipe nuts from the fuel injection pump and injectors, 1. Remove the pipes as an assembly.
2. Remove the spring clamp and fuel return hose, 2.

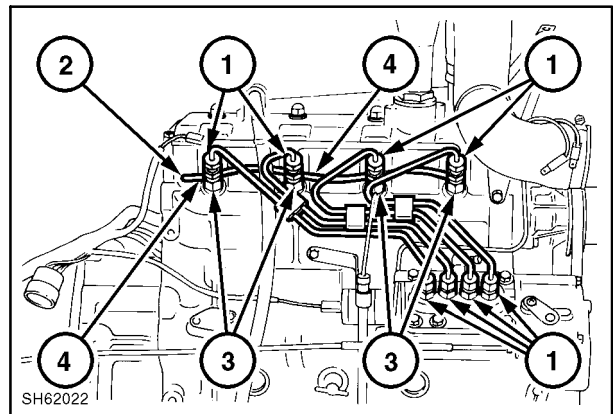

15

INJECTOR

Removal

Loosen and remove the securing nuts, 3. Remove the leak-off rail, 4. Remove the aluminum washers and discard. Remove the injectors tagging or marking with the cylinder they were removed from.

WATER PUMP

Removal

Loosen the securing bolts and remove the water pump assembly, 1, and set plate, 2.

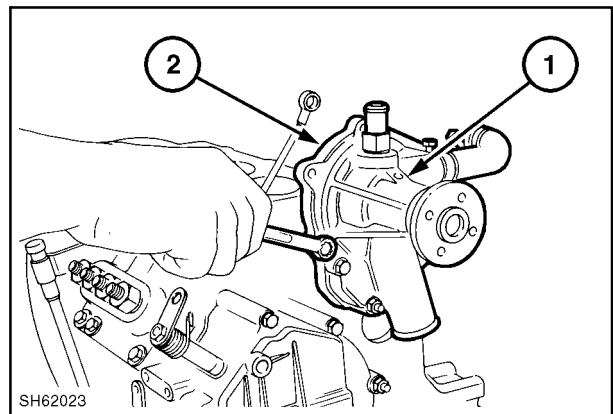

16

COVER/INTAKE MANIFOLD/EXHAUST MANIFOLD

Removal

Remove the intake manifold, 1, spacer, 2, and exhaust manifold, 3.

For the N844L-T turbocharged engine, refer to the turbocharger section of the manual for removal and replacement.

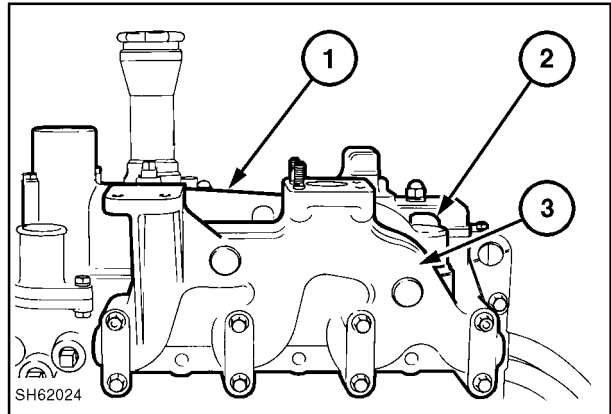

17

Loosen and remove four cap nuts with washers. Remove the head cover assembly, 1.

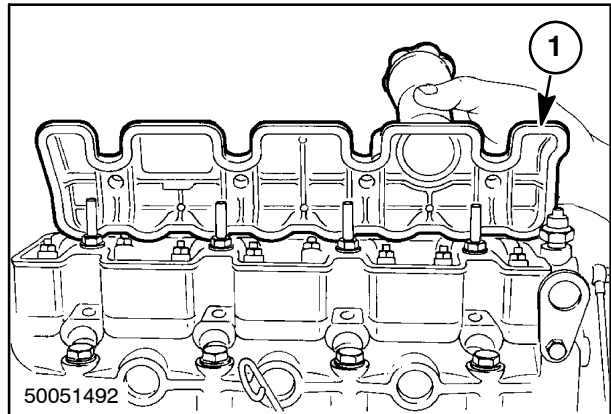

18

EXTERNAL OIL PIPE

Removal

1. Loosen and remove the two banjo bolts, 1, at the cylinder block main oil gallery and cylinder head assembly.
2. Remove the clamp, 2, from the fuel injection pump.

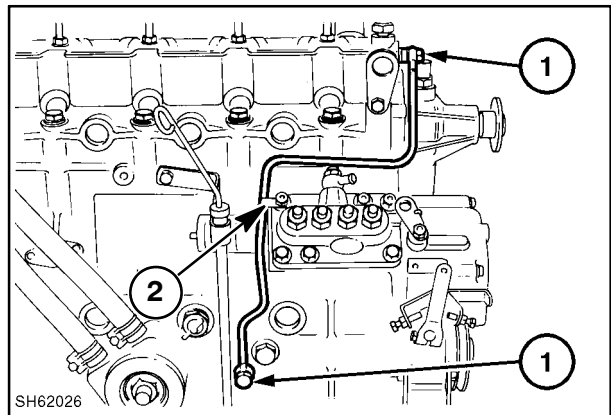

19

**Thank you very much
for your reading.**

**Please click here to buy
After you pay.**

**Then, you can
download the complete
manual instantly.
No waiting.**