

NEW HOLLAND

3010S

4010S

5010S

**REPAIR
MANUAL**



3010S, 4010S, 5010S TRACTORS REPAIR MANUAL

CONTENTS

SECTION 0 - INTRODUCTION	0-3
SECTION 1 - ENGINE	1-1
SECTION 2 - ELECTRICAL SYSTEM	2-1
SECTION 3 - POWER TRAIN	3-1
SECTION 4 - HYDRAULIC LIFT	4-1
SECTION 5 - TWO-WHEEL DRIVE FRONT AXLE AND STEERING	5-1
SECTION 6 - FOUR-WHEEL DRIVE FRONT AXLE	6-1
SECTION 7 - SPECIAL TOOLS	7-1
INDEX	7-6

ENGINE Disassembly

—  **CAUTION**  —

Handle all parts carefully. Do not put your hands or fingers between parts.
Wear suitable safety clothing - safety goggles, gloves and shoes.

1. Loosen the alternator pivot bolt.
2. Loosen the belt tension adjustment bolt (1).
3. Release the belt tension adjustment arm by undoing the retaining nut.
4. Remove the alternator and coolant pump drive belt.

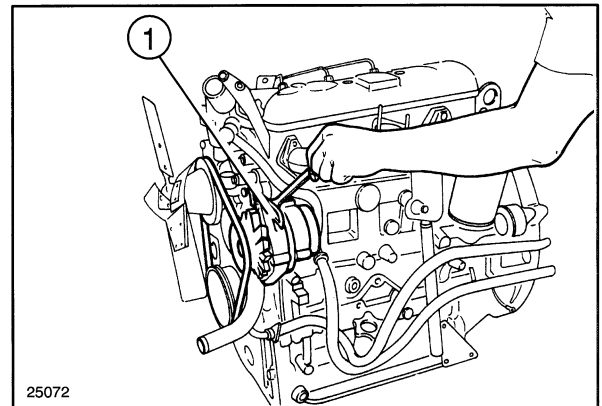

Figure 1-15

5. Unscrew the bolts securing the fan (1) and pulley to the coolant pump and remove the fan and pulley.

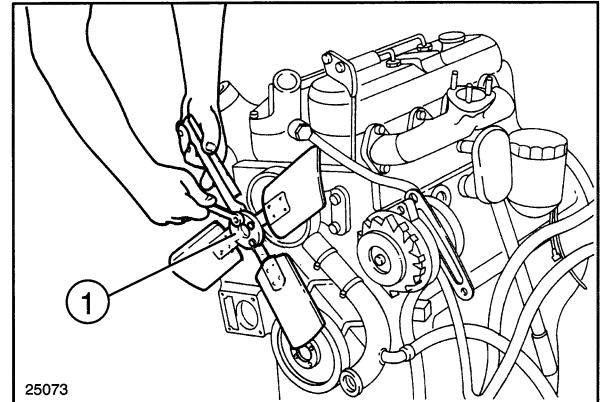

Figure 1-16

6. Remove the union in order to gain access to the pump retaining bolt.

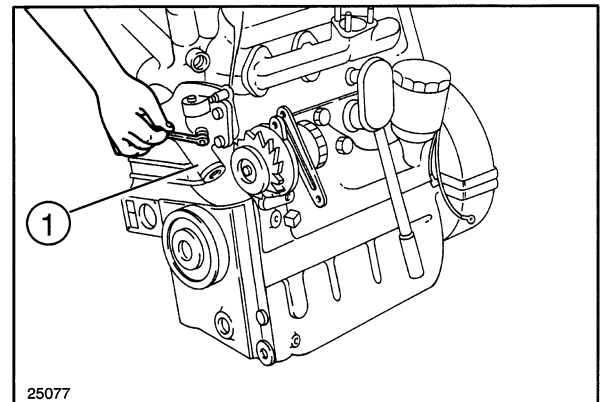

Figure 1-17

SECTION 1 - ENGINE

7. Unscrew the coolant pump retaining bolts (1) and remove the pump.

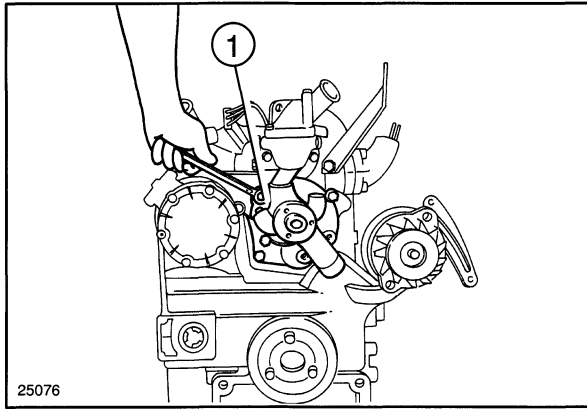

Figure 1-18

8. Unscrew the pump support bolts (1), the internal support bolt and remove the support.

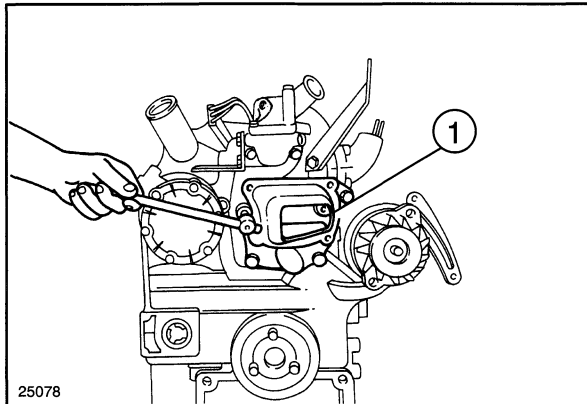

Figure 1-19

9. Undo the alternator support retaining bolts (1) and remove the complete alternator assembly.

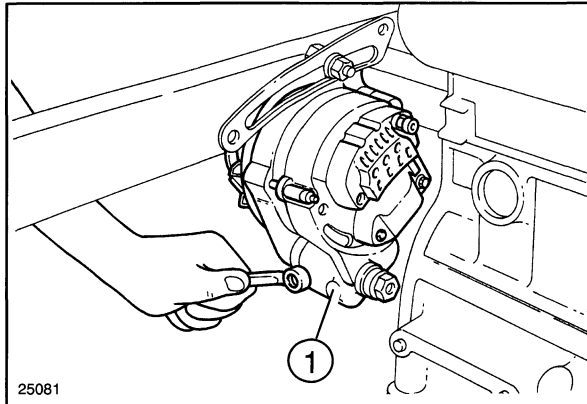

Figure 1-20

10. Unscrew the bolts (1) securing the exhaust manifold to the cylinder head and remove the manifold.

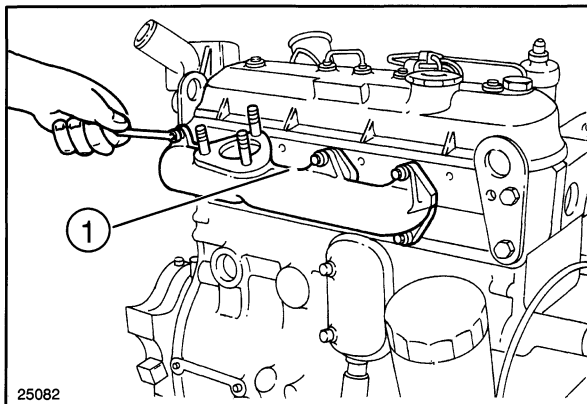

Figure 1-21

SECTION 1 - ENGINE

11. Remove the thermostat housing retaining bolts (1) and remove the thermostat housing.

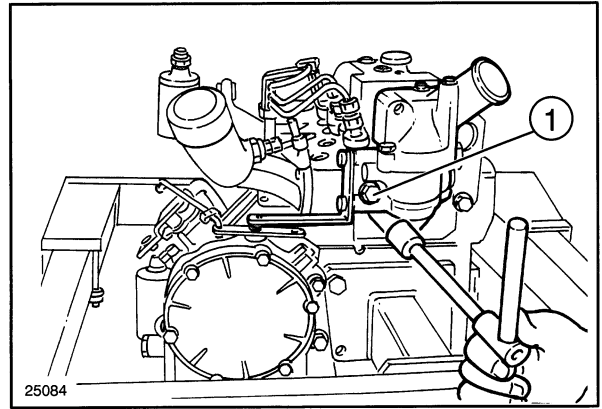

Figure 1-22

12. Unscrew the high pressure fuel line unions (1) on the injection pump and remove the fuel lines.

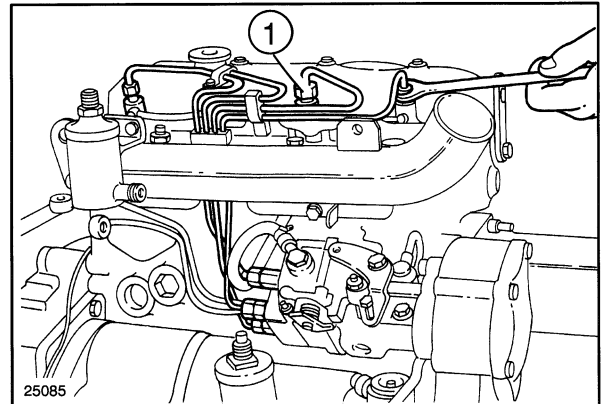

Figure 1-23

13. Unscrew the bolts (1) securing the inlet manifold to the cylinder head and remove the manifold.

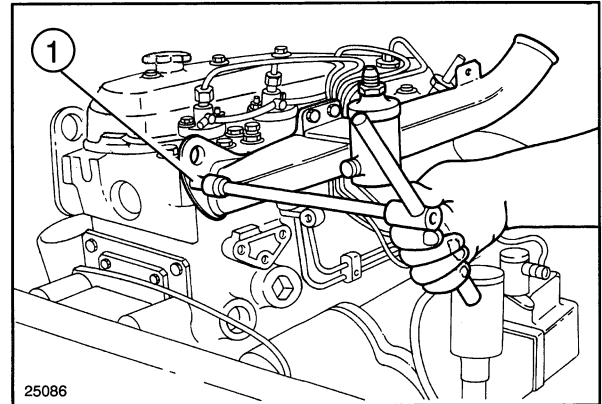

Figure 1-24

14. Unscrew the unions (1) on the fuel supply pump and detach the fuel lines.

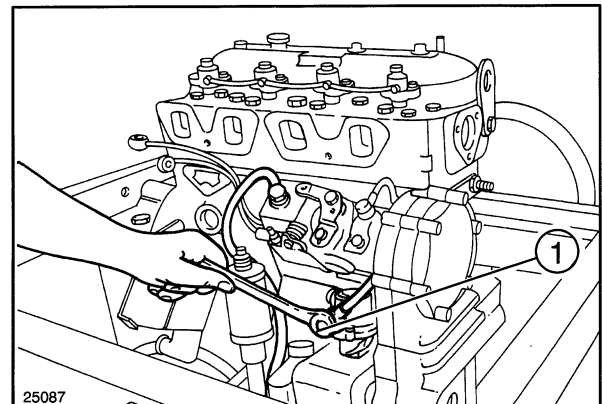

Figure 1-25

SECTION 1 - ENGINE

15. Undo screws (1) and remove the injection pump drive gear cover.

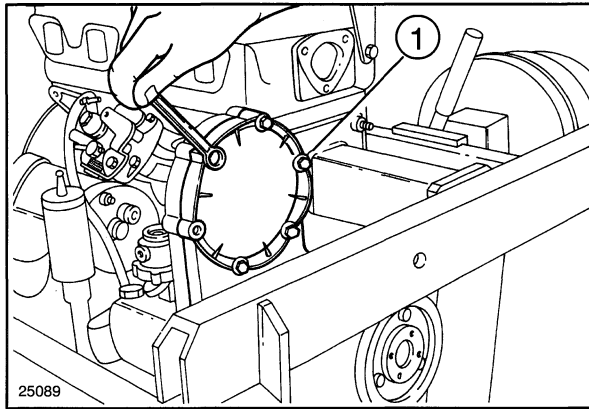

Figure 1-26

16. Unscrew the nuts (1) securing the injection pump to the timing gear case.

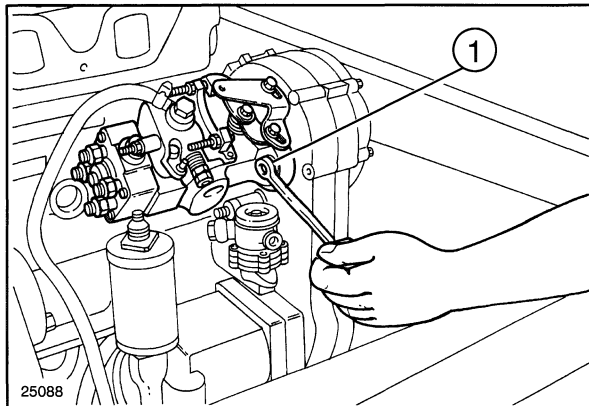

Figure 1-27

17. Unscrew the nut (1) securing the injection pump shaft to the drive gear.

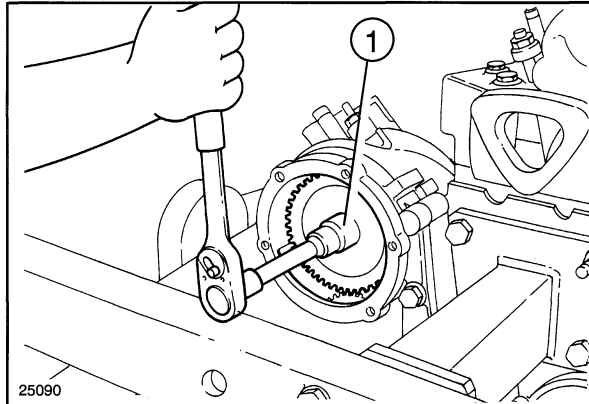

Figure 1-28

18. Withdraw the injection pump drive gear using tool 295942 (1) and recover the injection pump and the woodruff key.

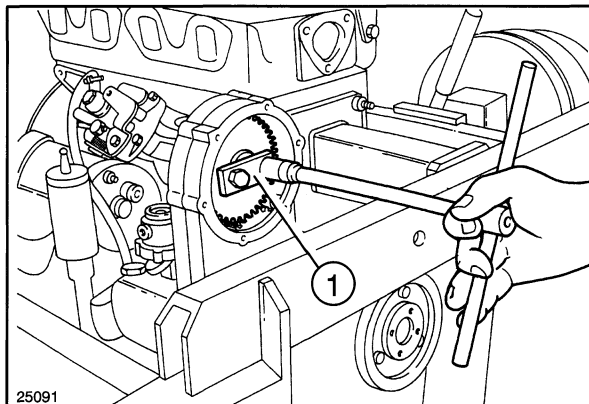

Figure 1-29

SECTION 1 - ENGINE

19. Undo the fuel line unions (1) on the fuel sedimentation filter.

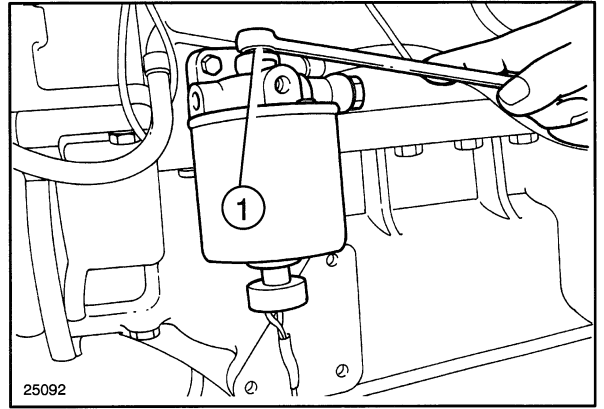

Figure 1-30

20. Unscrew the bolts securing the sedimentation filter support to the engine block and recover the complete filter assembly.

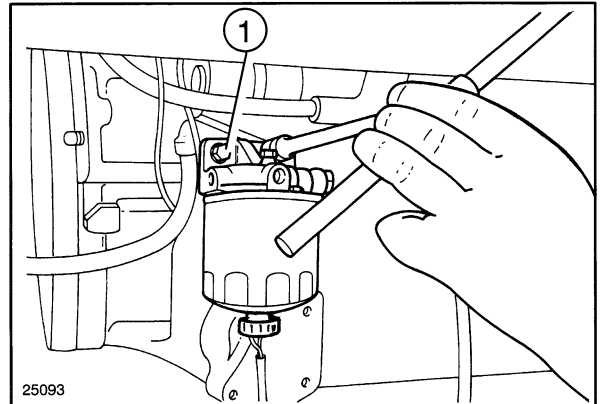

Figure 1-31

21. Unscrew the retaining nuts (1), remove the fuel pump support complete with the pump and recover the gasket.

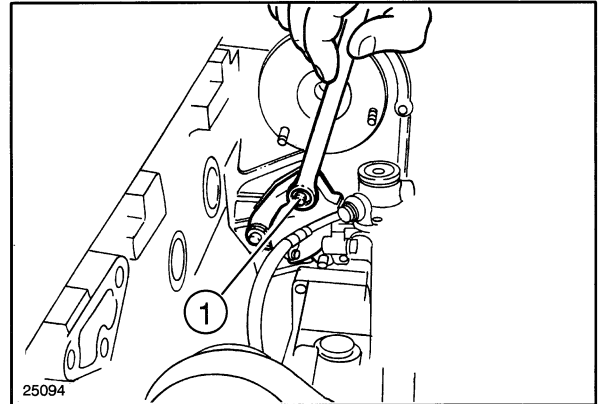

Figure 1-32

22. Unscrew the power steering pump retaining bolts (1) and remove the pump complete with filter and accumulator on the delivery line.

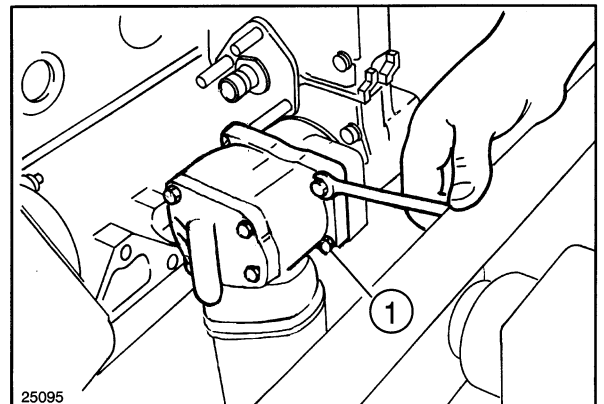

Figure 1-33

**Thank you very much
for your reading.**

**Please click here to buy
After you pay.**

**Then, you can
download the complete
manual instantly.
No waiting.**