

Product: MULTI TERRAIN LOADER

Model: 247B3 MULTI TERRAIN LOADER ESL

Configuration: 247B3 Multi Terrain Loader ESL00001-UP (MACHINE) POWERED BY C2.2 Engine

Disassembly and Assembly

247B, 247B2, 257B and 257B2 Multi Terrain Loaders Power Train

Media Number -REN4874-05

Publication Date -01/07/2018

Date Updated -11/07/2018

i02061094

Piston Motor (Hydrostatic) - Disassemble

SMCS - 5058-015-H7

S/N - ESL1-UP

S/N - KB31-UP

S/N - MTL1-5074

S/N - SLK1-7299

Disassembly Procedure

Table 1

Required Tools			
Tool	Part Number	Part Description	Qty
A	1P-0520	Driver Gp	1
B	1U-7280	Pin Punch	1
C	1P-0510	Driver Gp	1
D	2P-8312	Retaining Ring Pliers	1
E	1U-7276	Pin Punch	1
F	8B-5144	Bolts (5/8 inch by 18 NF by 3 inch)	2
G	8H-0663	Bearing Puller	1
H	6V-5839	Washers	4
	6V-8214	Bolts (6 mm by 1.00 NC by 20 mm)	4
	9M-1974	Hard Washers	4

Start By:

- a. Remove track drive. Refer to Disassembly and Assembly, "Track Drive - Remove".

Note: The following procedure is intended for cleaning purposes only.



Illustration 1

g00882206

! WARNING

Personal injury can result from being struck by parts propelled by a released spring force.

Make sure to wear all necessary protective equipment.

Follow the recommended procedure and use all recommended tooling to release the spring force.

1. Mark the piston motor for assembly purposes. Remove bolts (1). Remove cover (2).



2. Remove gasket (3).



Illustration 3

3. Remove washer (4). Remove disc spring (5). Remove fitting (6).



Illustration 4

4. Install Tooling (H). **Use low pressure compressed air to remove piston (7).**

Note: Low pressure air is required in order to allow the piston to release from the motor.

Note: Tooling (H) is required in order to prevent damage to the piston.



Illustration 5

g00882222

5. Remove seal (8) from piston (7).

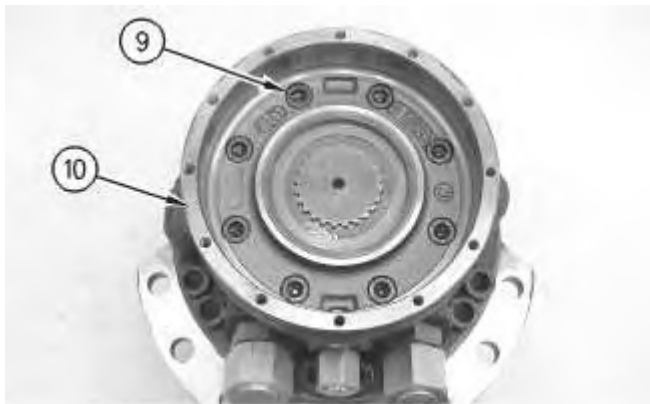

Illustration 6

g00882227

6. Remove bolts (9). Remove brake housing (10).

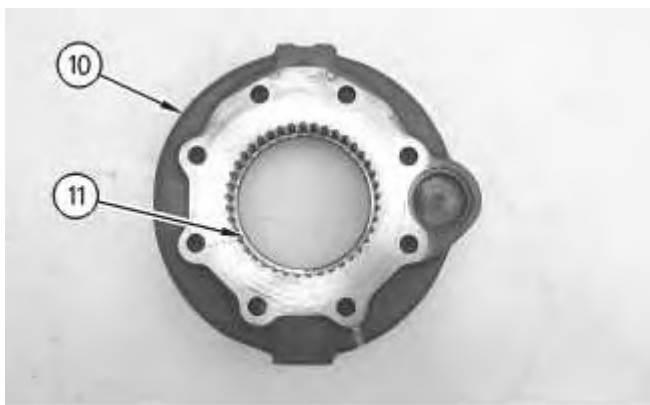

Illustration 7

g00882234



Illustration 8

g00882240

7. Use Tooling (A) to remove seal (11) from brake housing (10).

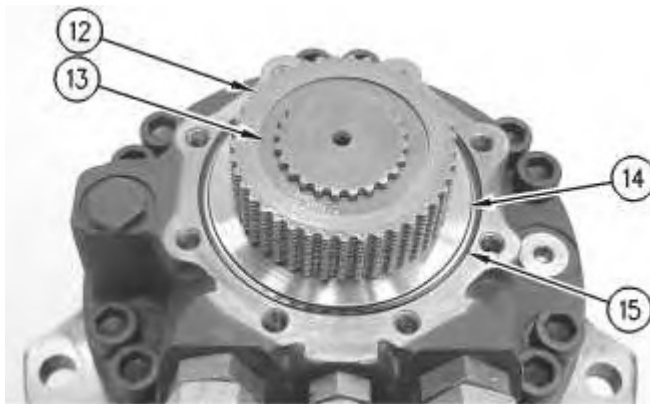

Illustration 9

g00882243

8. Remove discs (12) from the outer spline. Remove discs (13) from the inner spline. Remove shim (14). Remove O-ring seal (15).



Illustration 10

g00882248



Illustration 11

g00882264

Note: Observe the shaft's direction.

9. Remove shaft (16).



Illustration 12

g00882271

10. Remove fittings (19). Remove bolts (18). Remove rear case (17).



Illustration 13

g00882348



Illustration 14

g00882350

11. Use Tooling (B) to remove distributor (20) from rear case (17). Remove springs (21). Remove pin (22). Remove O-ring seals (23).

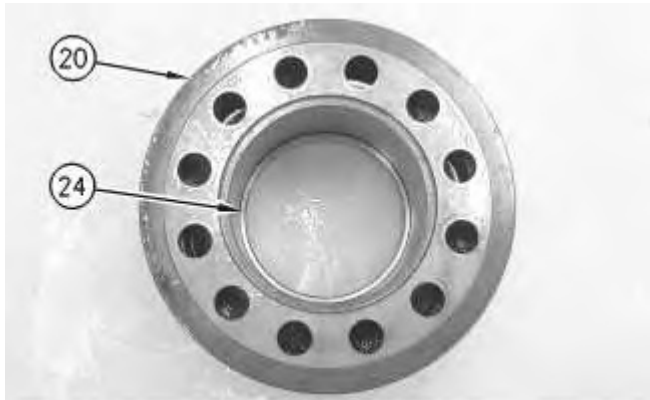

Illustration 15

g00882353

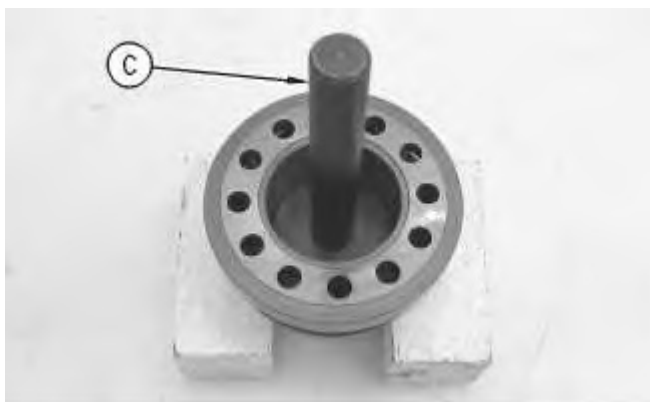

Illustration 16

g00882358

12. Block distributor (20). Use Tooling (C) to remove bushing (24).

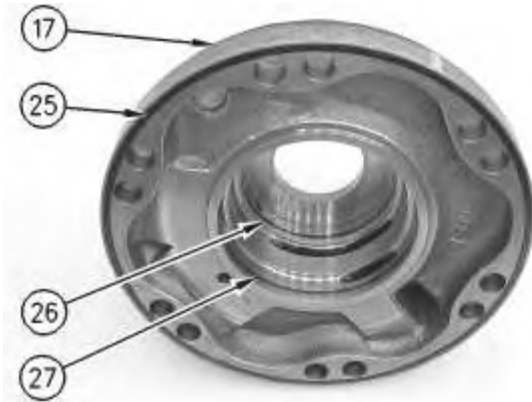

Illustration 17

g00882374

13. Remove O-ring seal (25). Remove O-ring seal (26). Remove O-ring seal (27).



Illustration 18

g00886692

14. Remove plug (28). Remove O-ring seal (29).



Illustration 19

g00886645



WARNING

Personal injury can result from being struck by parts propelled by a released spring force.

Make sure to wear all necessary protective equipment.

Follow the recommended procedure and use all recommended tooling to release the spring force.

15. Remove plug (34). Remove O-ring seal (33). Remove spring (32).

16. Remove washer (31). Remove spool (30).

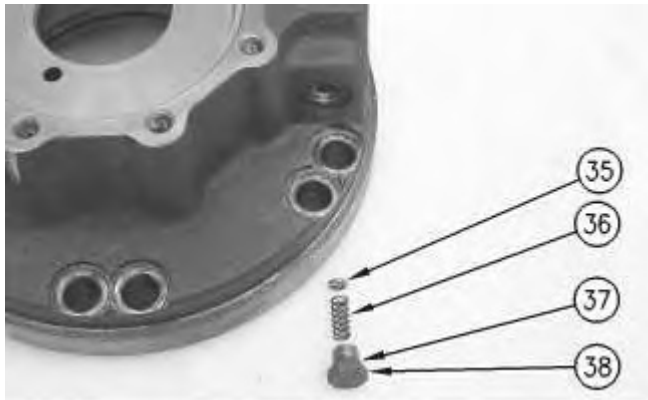

Illustration 20

g00886642

! WARNING

Personal injury can result from being struck by parts propelled by a released spring force.

Make sure to wear all necessary protective equipment.

Follow the recommended procedure and use all recommended tooling to release the spring force.

17. Remove plug (38). Remove O-ring seal (37). Remove spring (36).

18. Remove washer (35).



Illustration 21

g00883066

19. Remove cam ring (39).



Illustration 22

g00883099

20. Remove rotor (40). Remove O-ring seal (41).

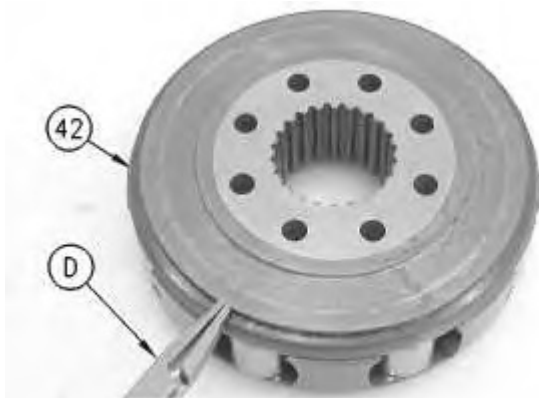

Illustration 23

g00883103

**Thank you very much
for your reading.**

**Please click here to buy
After you pay.**

**Then, you can
download the complete
manual instantly.
No waiting.**