

## 2007 Accessories & Equipment

### Frame and Underbody - Corvette

## SPECIFICATIONS

### FASTENER TIGHTENING SPECIFICATIONS

#### Fastener Tightening Specifications

Application	Specification	
	Metric	English
Crossmember Bolt Nut	110 N.m	81 lb ft
Fuel Door Pocket Screws	2 N.m	18 lb in
Fuel Door Screws	2 N.m	18 lb in
Power Steering Gear Mounting Bolts	100 N.m	74 lb ft
Quarter Panel Screws	5 N.m	44 lb in
Quarter Panel to Brace Screws	5 N.m	44 lb in
Rear Bumper Fascia Bolts	2 N.m	18 lb in
Shock Absorber Lower Mounting Nuts	28 N.m	21 lb ft
Skid Bar to Frame Bolts	50 N.m	36 lb ft

## REPAIR INSTRUCTIONS

### FRONT TOW HOOK REPLACEMENT

#### Removal Procedure

1. Disable the SIR system. Refer to **SIR Disabling and Enabling** .
2. Disconnect the negative battery cable. Refer to **Battery Negative Cable Disconnection and Connection (6.0L)** or **Battery Negative Cable Disconnection and Connection (7.0L)** .
3. Remove all related panels and components.
4. Note the location and remove the sealers and anti-corrosion materials from the repair area, as necessary. Refer to **Anti-Corrosion Treatment and Repair** .

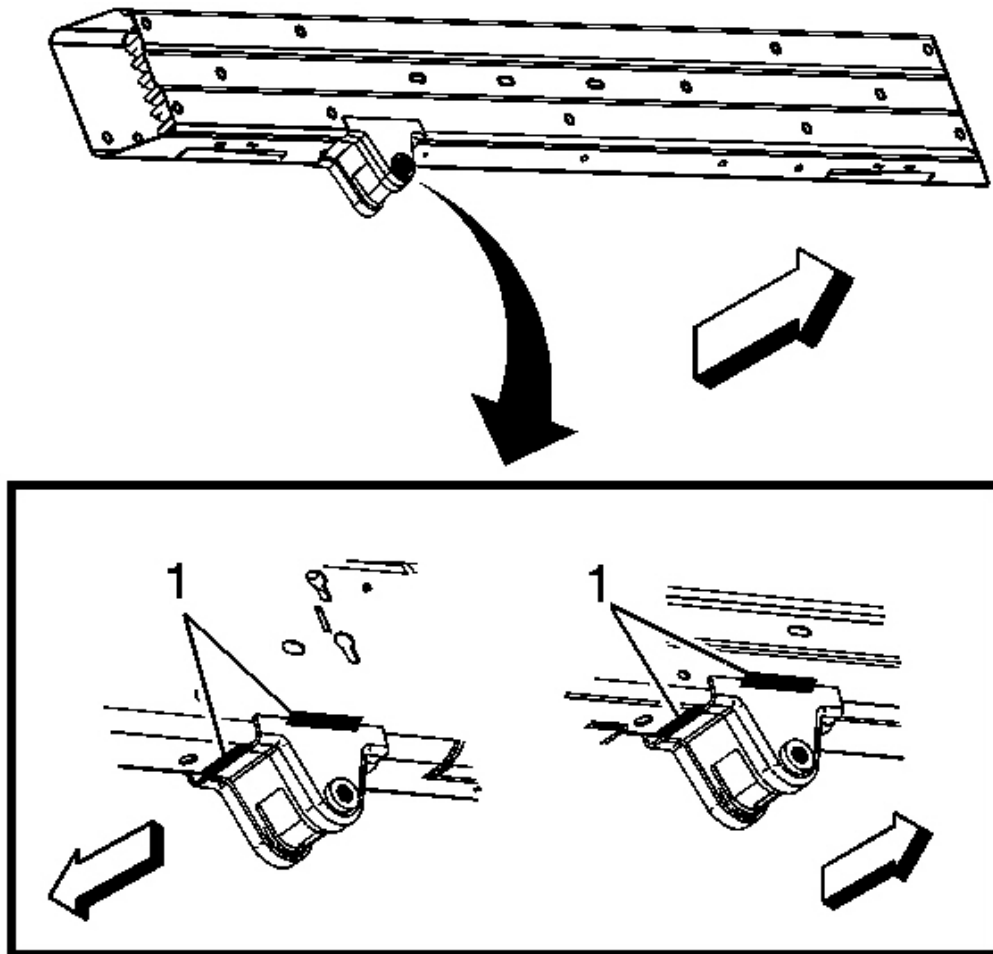

**Fig. 1: Identifying Welds - Front**  
Courtesy of GENERAL MOTORS CORP.

5. Remove the welds (1) attaching the tow hook to the impact bar.

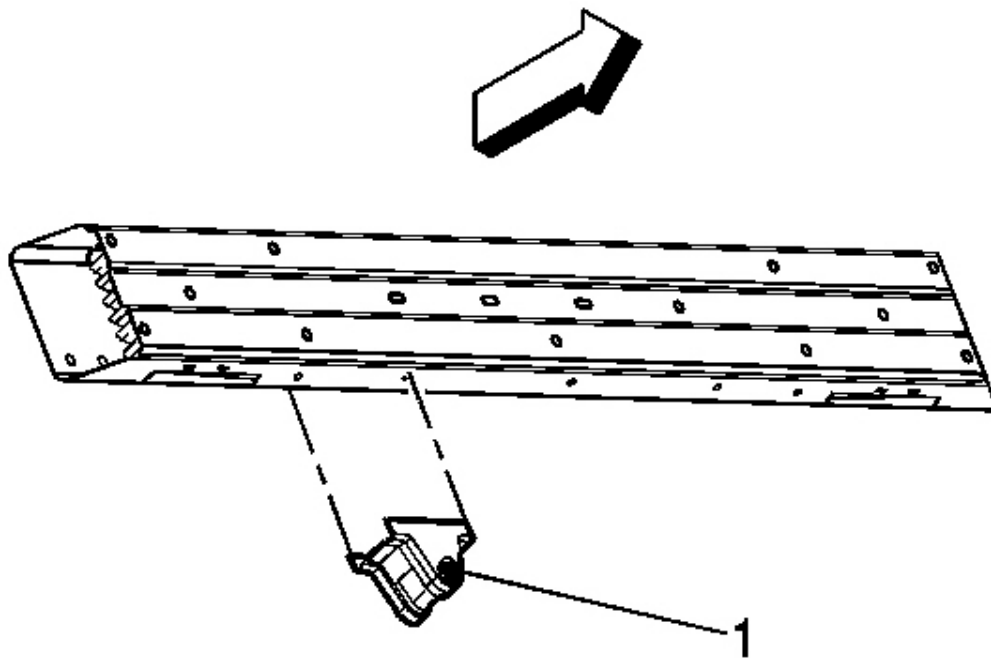
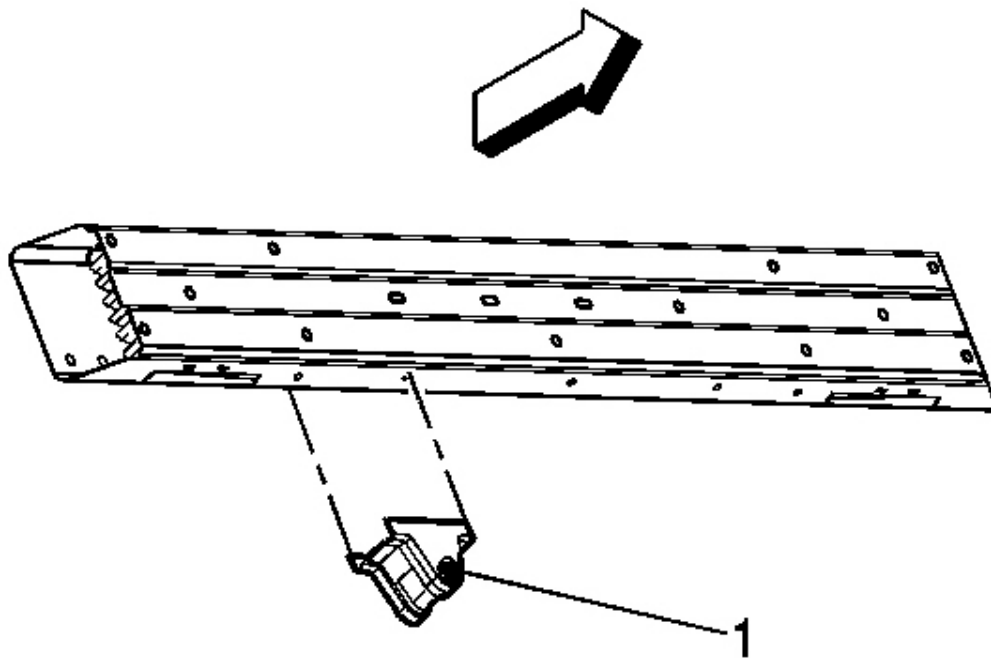

**Fig. 2: View Of Tow Hook - Front**  
**Courtesy of GENERAL MOTORS CORP.**

6. Remove the tow hook (1) from the impact bar.

**Installation Procedure**

1. Clean and prepare all of the welded surface and apply 3M weld-thru coating P/N 05916 or equivalent as necessary.



**Fig. 3: View Of Tow Hook - Front**  
**Courtesy of GENERAL MOTORS CORP.**

2. Position the tow hook (1) to the passenger side of the impact bar.

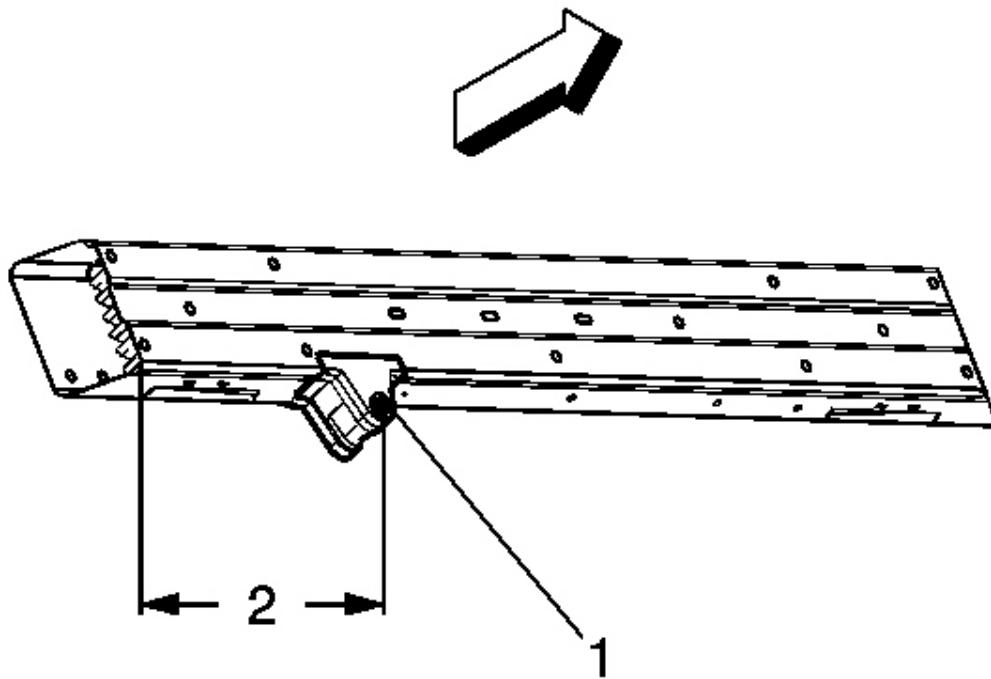

**Fig. 4: View Of Tow Hook & Impact Bar - Front**  
**Courtesy of GENERAL MOTORS CORP.**

3. From the right outer edge of the impact bar (2) measure 269 mm (10 5/8 in) to the center of the tow hook (1).

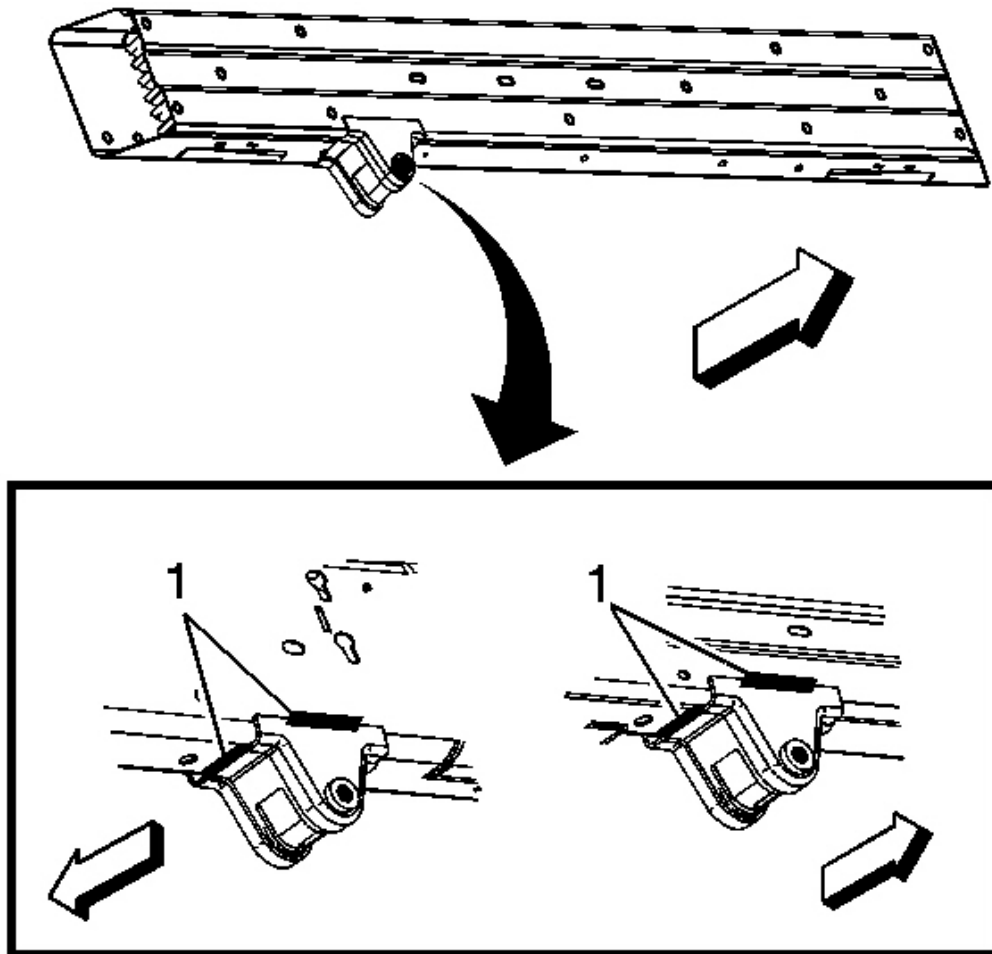

**Fig. 5: View Of Welds - Front**  
Courtesy of GENERAL MOTORS CORP.

4. Using a metal inert gas (MIG) welder, weld a 51 mm (2 in) stitch along the tow hook to the impact bar in 4 places (1).
  - Front
  - Rear
  - Inboard side
  - Outboard side
5. Apply the sealers and anti-corrosion materials to the repair area, as necessary. Refer to

## **Anti-Corrosion Treatment and Repair** .

6. Paint the repair area. Refer to **Basecoat/Clearcoat Paint Systems** .
7. Install all related panels and components.
8. Connect the negative battery cable. Refer to **Battery Negative Cable Disconnection and Connection (6.0L)** or **Battery Negative Cable Disconnection and Connection (7.0L)** .
9. Enable the SIR system. Refer to **SIR Disabling and Enabling** .

## **REAR TOW HOOK REPLACEMENT**

### **Removal Procedure**

1. Disable the SIR system. Refer to **SIR Disabling and Enabling** .
2. Disconnect the negative battery cable. Refer to **Battery Negative Cable Disconnection and Connection (6.0L)** or **Battery Negative Cable Disconnection and Connection (7.0L)** .
3. Remove all related panels and components.
4. Note the location and remove the sealers and anti-corrosion materials from the repair area, as necessary. Refer to **Anti-Corrosion Treatment and Repair** .

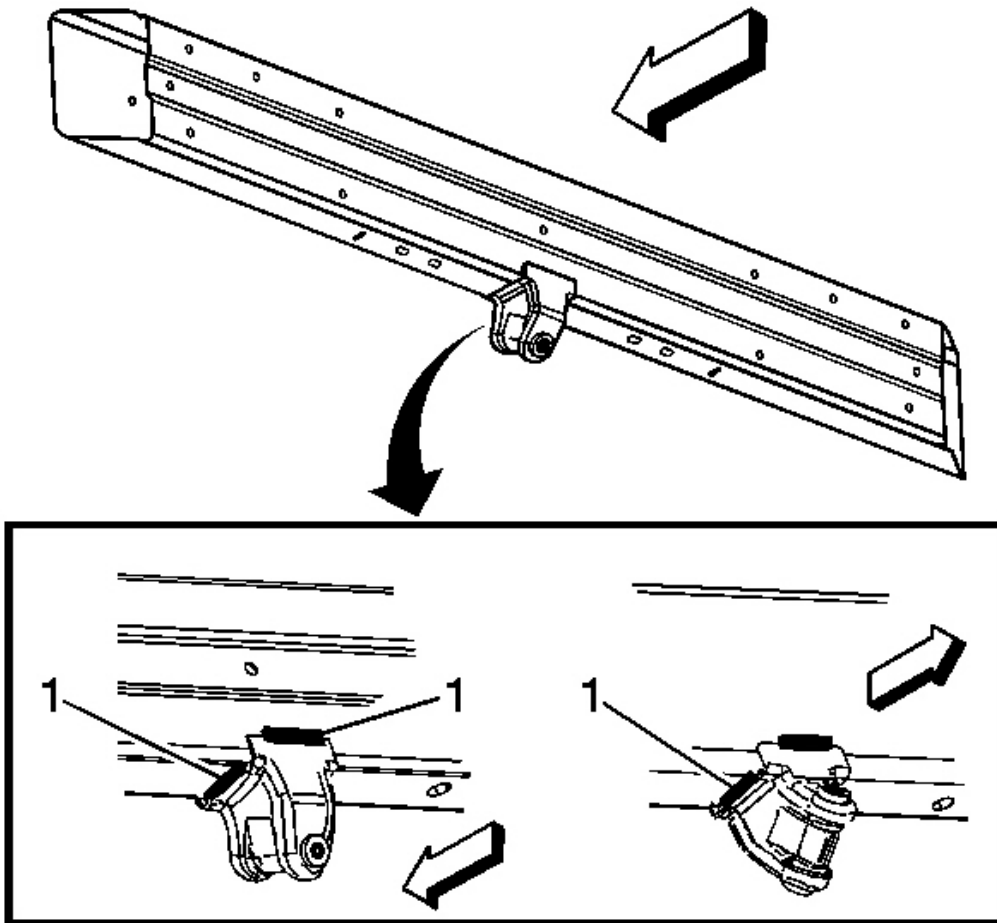

**Fig. 6: View Of Welds - Rear**  
**Courtesy of GENERAL MOTORS CORP.**

5. Remove the welds (1) attaching the tow hook to the impact bar.



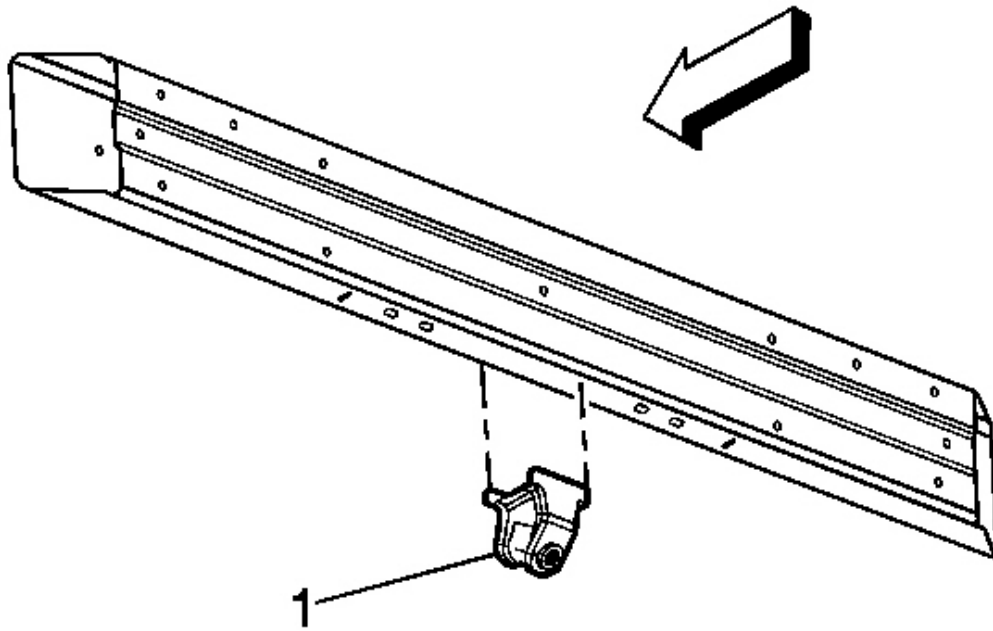
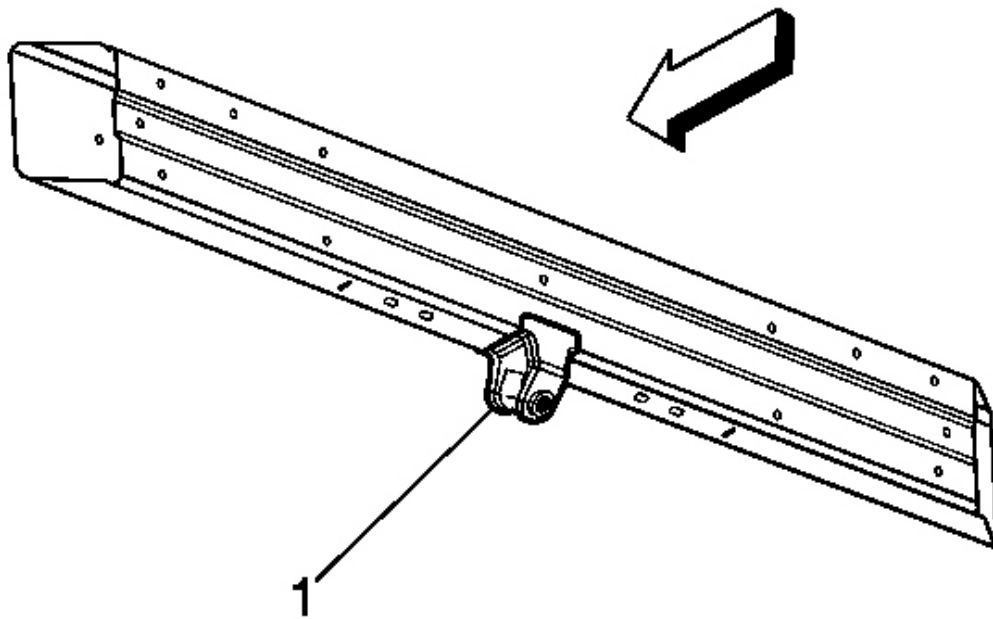

**Fig. 7: View Of Tow Hook - Rear**  
**Courtesy of GENERAL MOTORS CORP.**

6. Remove the tow hook (1) from the impact bar.

**Installation Procedure**

1. Clean and prepare all of the welded surface and apply 3M weld-thru coating P/N 05916 or equivalent as necessary.



**Fig. 8: Positioning Tow Hook - Rear**  
**Courtesy of GENERAL MOTORS CORP.**

2. Position the tow hook (1) to the center of the impact bar.

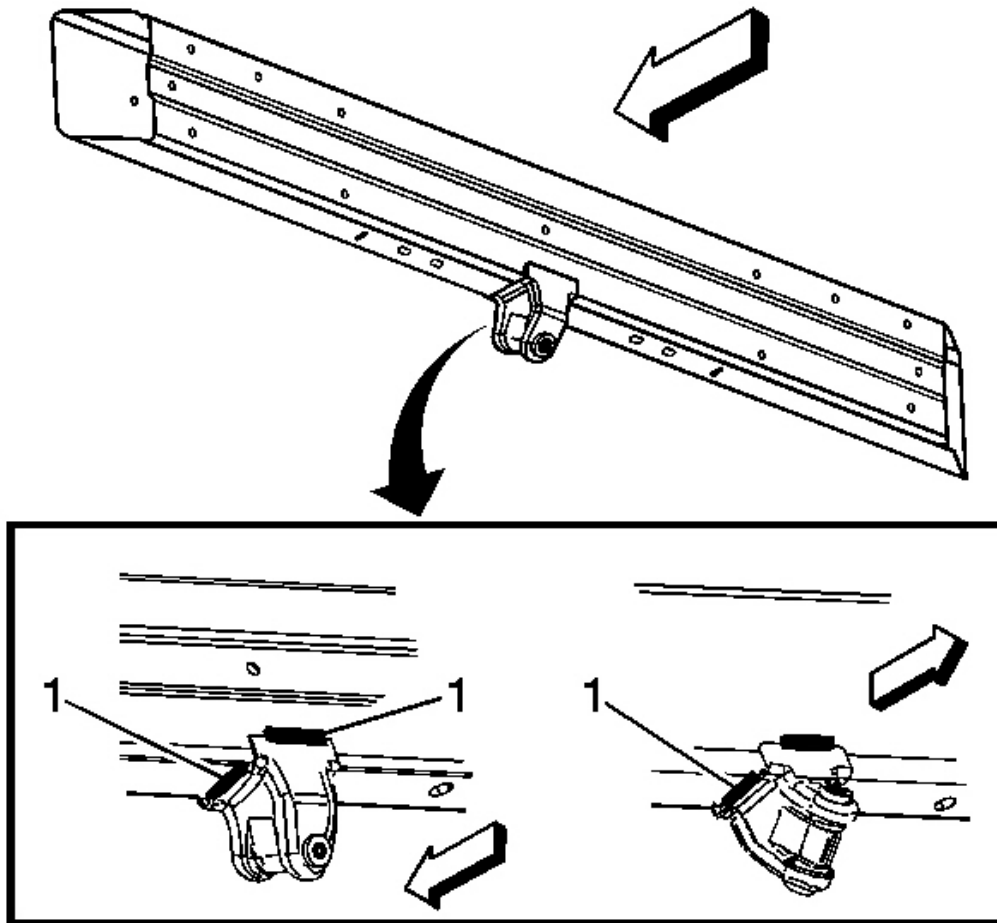

**Fig. 9: View Of Welds - Rear**  
**Courtesy of GENERAL MOTORS CORP.**

3. Using a metal inert gas (MIG) welder, weld a 51 mm (2 in) stitch along the tow hook to the impact bar in 4 places (1).
  - Front
  - Rear
  - Inboard side
  - Outboard side
4. Apply the sealers and anti-corrosion materials to the repair area, as necessary. Refer to **Anti-Corrosion Treatment and Repair** .

5. Paint the repair area. Refer to **Basecoat/Clearcoat Paint Systems** .
6. Install all related panels and components.
7. Connect the negative battery cable. Refer to **Battery Negative Cable Disconnection and Connection (6.0L)** or **Battery Negative Cable Disconnection and Connection (7.0L)** .
8. Enable the SIR system. Refer to **SIR Disabling and Enabling** .

## **SKID BAR REPLACEMENT**

### **Removal Procedure**

1. Raise and support the vehicle. Refer to **Lifting and Jacking the Vehicle** .
2. Remove the front fascia. Refer to **Front Bumper Fascia Replacement** .
3. Remove all related panels and components.
4. Support the radiator assembly.
5. Support the skid bar.

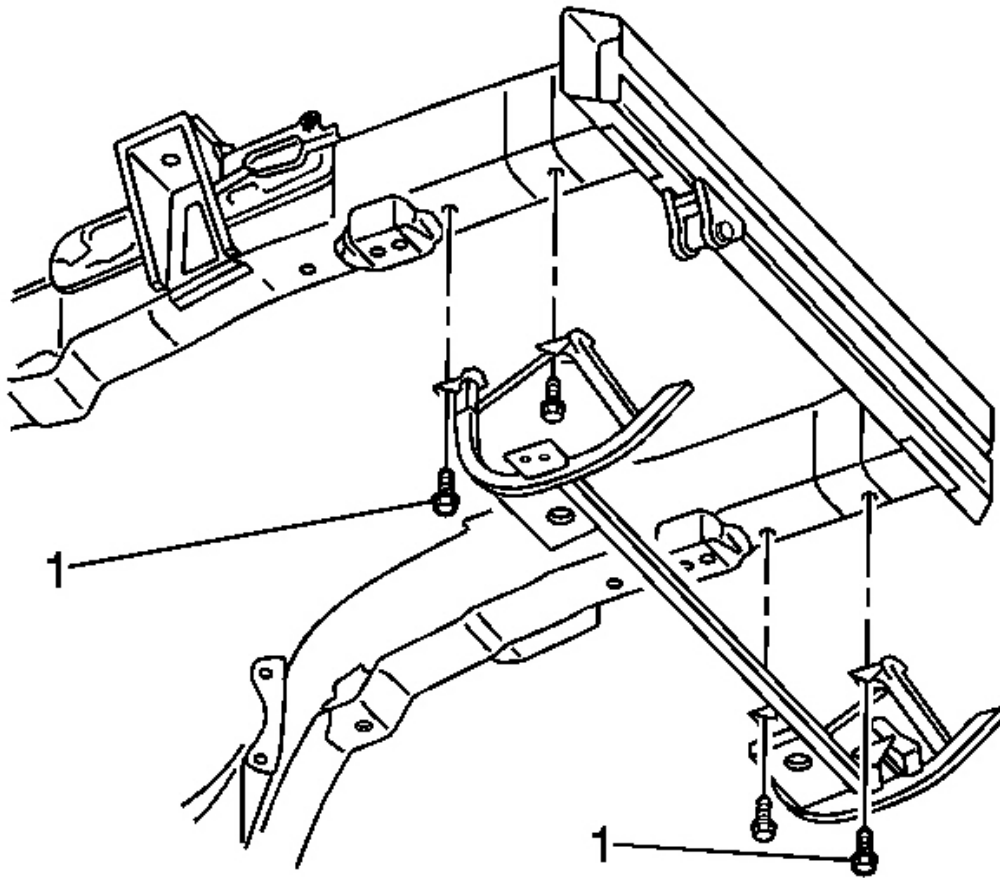
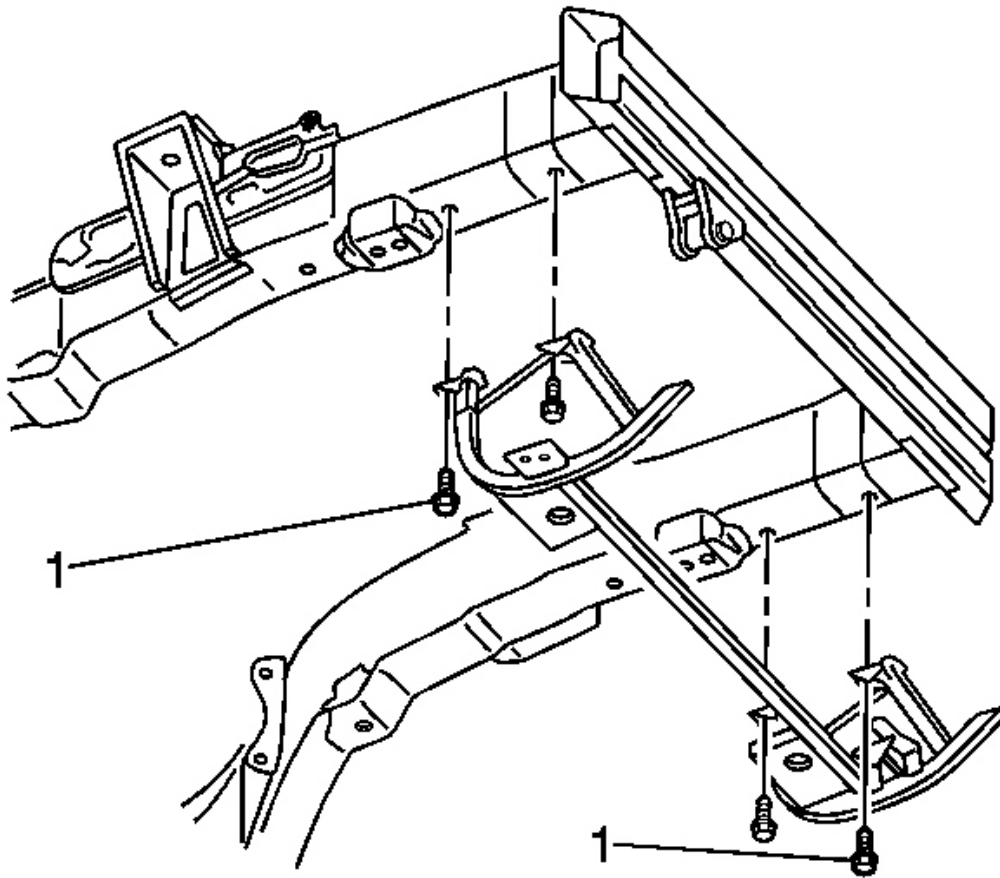

**Fig. 10: View Of Skid Bar Bolts**  
**Courtesy of GENERAL MOTORS CORP.**

6. Remove the 4 bolts (1) attaching the skid bar to the frame rails.
7. Remove the skid bar.
8. Save all of the brackets, mounting studs, and accessories for transfer to the new skid bar.

**Installation Procedure**

1. Transfer all of the brackets, mounting studs, and accessories to the new skid bar.
2. Position the skid bar to the frame rails.



**Fig. 11: View Of Skid Bar Bolts**  
Courtesy of GENERAL MOTORS CORP.

**NOTE:** Refer to Fastener Notice .

3. Install the 4 bolts (1) attaching the skid bar to the frame rails.

**Tighten:** Tighten the bolts to 50 N.m (36 lb ft).

4. Install all related panels and components.
5. Install the front fascia. Refer to Front Bumper Fascia Replacement .
6. Lower the vehicle.

## FRONT CROSSMEMBER BOLT REPLACEMENT

### Removal Procedure

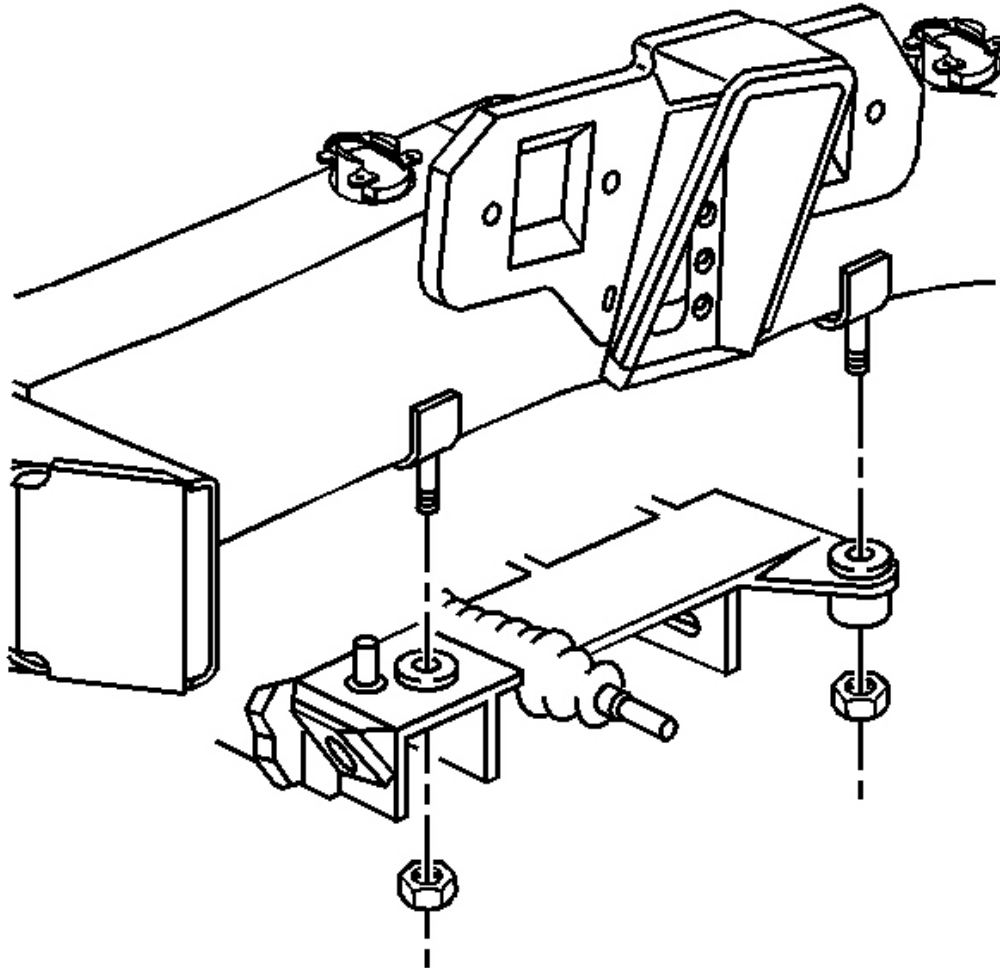

**Fig. 12: View of Crossmember Nut & Bolt - Front**  
**Courtesy of GENERAL MOTORS CORP.**

1. Raise and suitably support the vehicle. Refer to **Lifting and Jacking the Vehicle** in General Information.
2. Use hand tools to remove the nut from the bolt that you are replacing.
3. Lower the vehicle.

4. Open the hood.
5. Remove the battery heat shield, if removing the right rear bolt only. Refer to **Battery Heat Shield Replacement** in Engine Electrical.

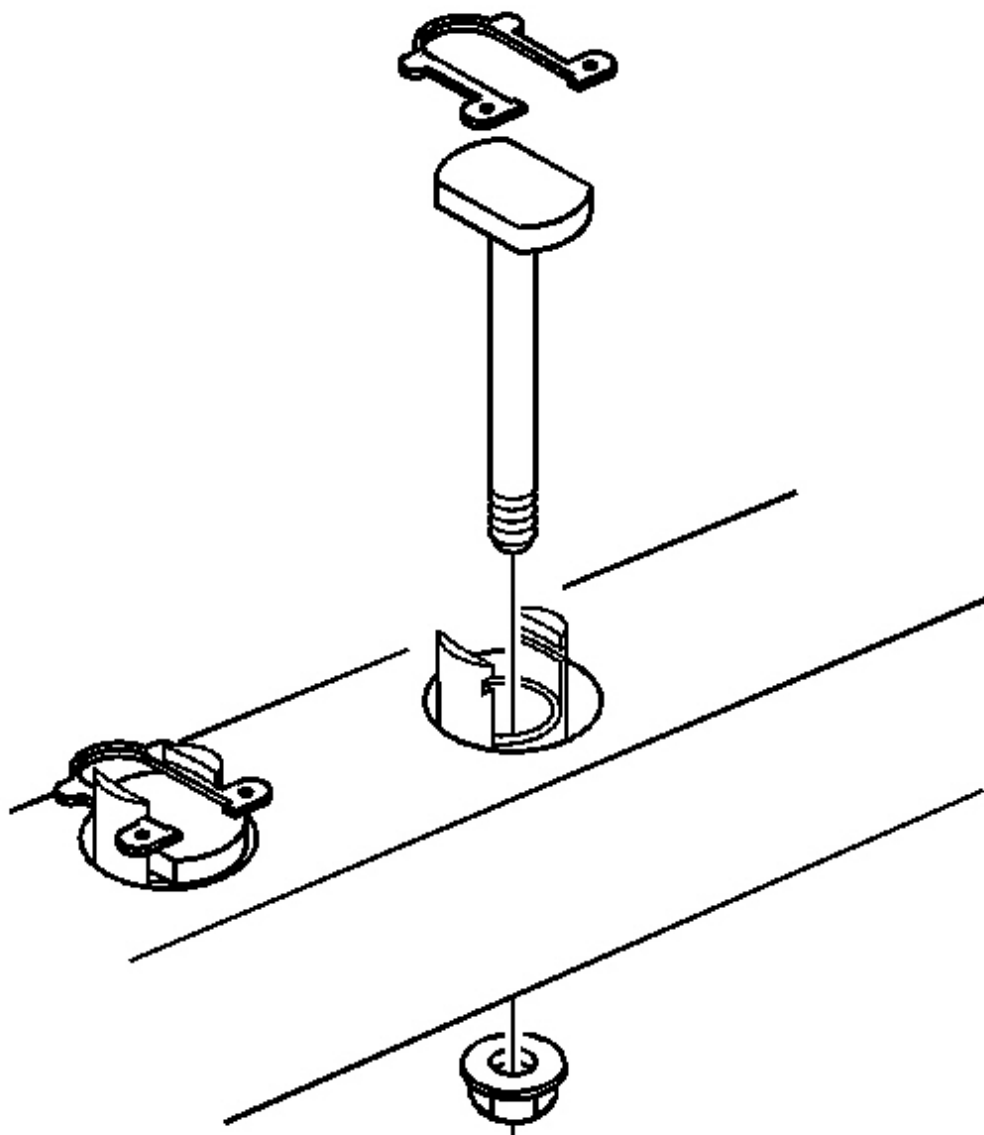
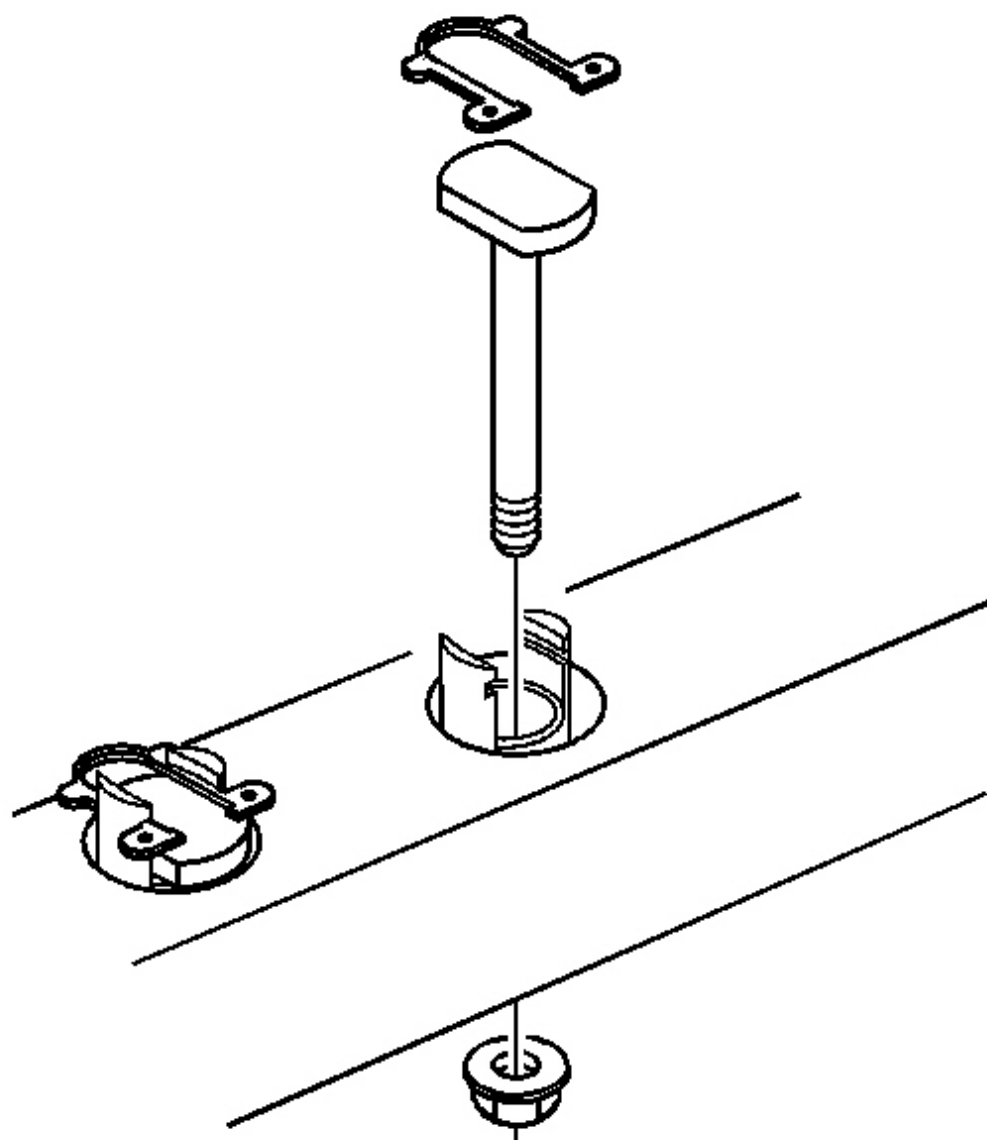

**Fig. 13: View Of Crossmember Bolt & Spring Clip - Front**  
Courtesy of GENERAL MOTORS CORP.



6. Use snap ring pliers to remove the spring clip.
7. Remove the bolt.

**Installation Procedure**

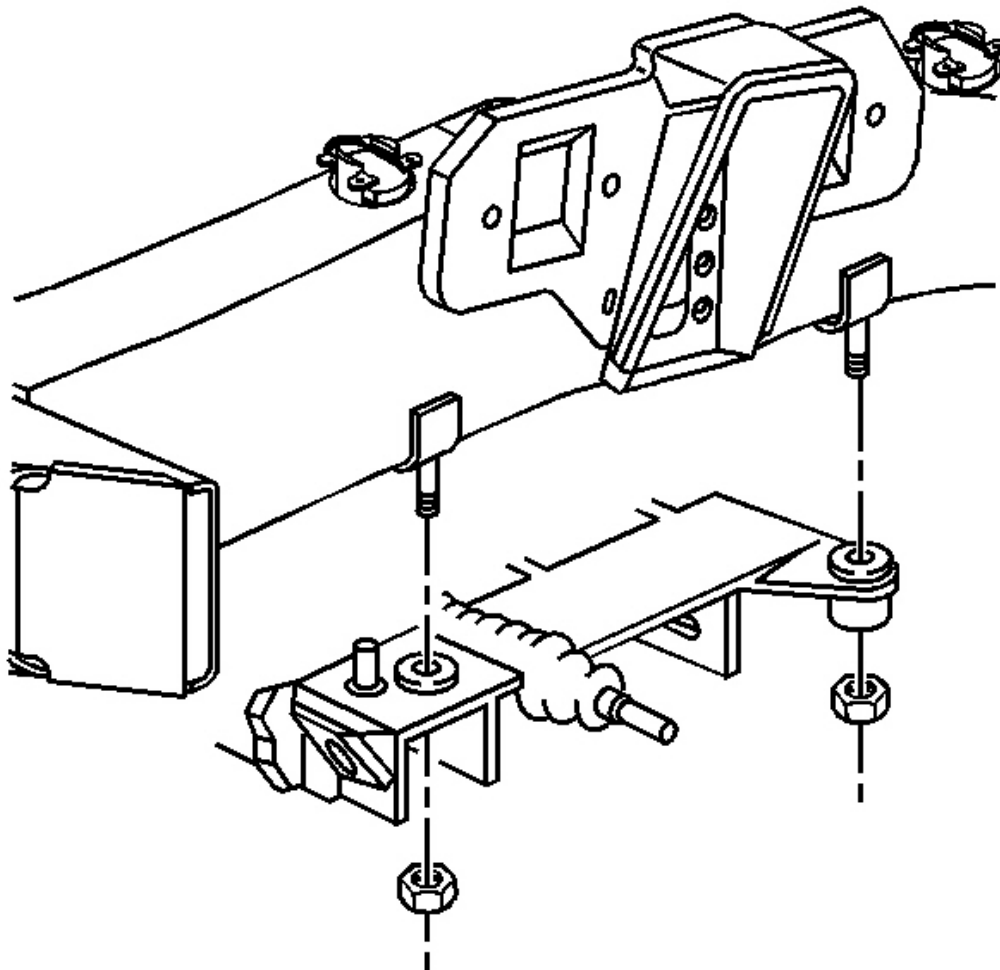

**Fig. 14: View Of Crossmember Bolt & Spring Clip - Front**

Courtesy of GENERAL MOTORS CORP.

**IMPORTANT:** Verify that you have selected a bolt of the proper length.

1. Install the crossmember bolt.
2. Use snap ring pliers to install the spring clip.



**Fig. 15: View of Crossmember Nut & Bolt - Front**  
Courtesy of GENERAL MOTORS CORP.

3. Raise and suitably support the vehicle. Refer to **Lifting and Jacking the Vehicle** in

**Thank you very much  
for your reading.**

**Please click here and go  
back to the website.**

**Then, you can  
download the complete  
manual instantly.**

**No waiting.**