

Document Title: Frame and track unit, description	Function Group: 700	Information Type: Service Information	Date: 2014/3/13
Profile: CWL, L50F [GB]			

Frame and track unit, description

The front frame is built as an open box profile on which is attached the lifting bracket that serves as a carrier for the fast change device with the working tools required. The front frame also fixes the front axle.

The rear frame consists of two frame carriers. The front frame carrier supports the resiliently mounted cab and fixes the rear axle. The engine and counterweight are attached to the rear frame carrier. The rear wing and steps are integrated in the frame.

The front frame is connected to the rear via the articulated joint. All fixing surfaces between the frames and components are machined to guarantee perfect fit and connection.

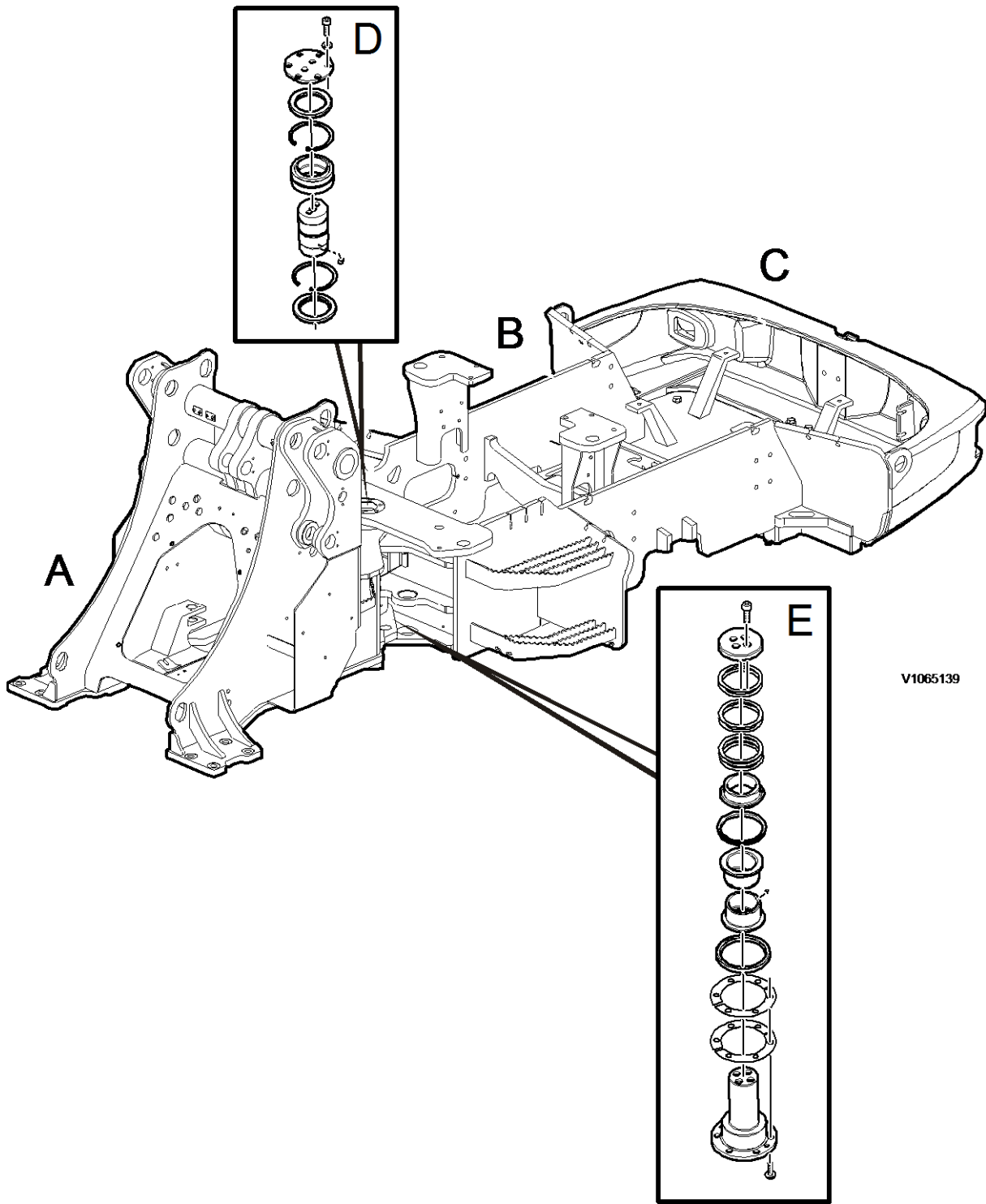

V1065139

Figure 1
Frame parts

- A. Front frame
- B. Rear frame
- C. Counterweight
- D. Upper frame joint bearing
- E. Lower frame joint bearing

Document Title: Counterweight, removing	Function Group: 716	Information Type: Service Information	Date: 2014/3/13
Profile: CWL, L50F [GB]			

Counterweight, removing

Op nbr 716-001

1. Place the machine in service position.
2. Switch off the battery connection switch.

WARNING

The work involves handling heavy components - failure to stay alert may result in severe crushing injuries.

3. Disconnect the pin plug connection (1) of the tail lights.

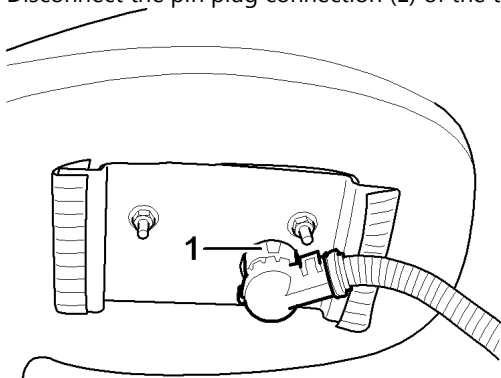

V1065086

Figure 1

4. Remove the engine hood catch (1) at the counterweight.

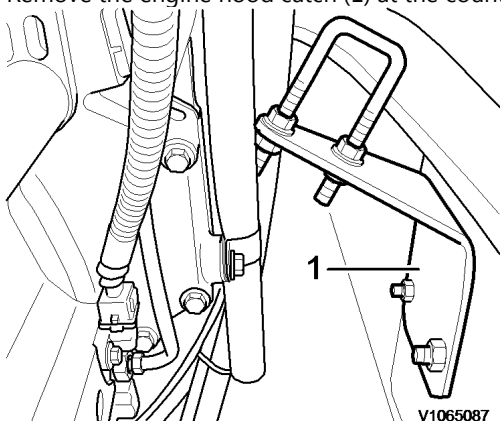

V1065087

Figure 2

5. Fit lifting device and attach to crane with a suitable lifting tool.

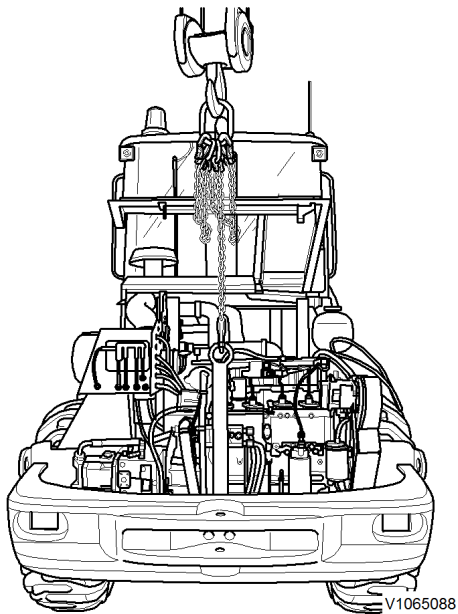

Figure 3

6. Remove retaining bracket (1) right and left, and fixing screws (2).

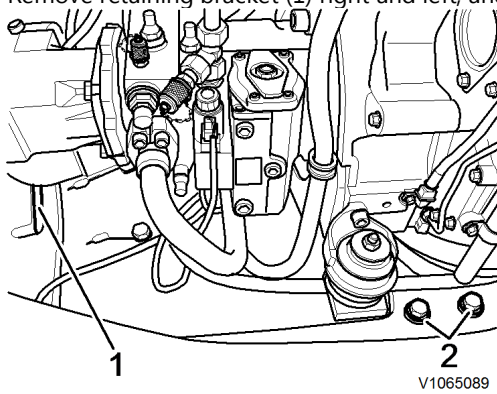

Figure 4

7. Slowly raise counterweight, remove towards the back and place on a suitable support.

NOTE!

Counterweight, weight: approx. 600 kg (1322 lb).

Document Title: Counterweight, fitting	Function Group: 716	Information Type: Service Information	Date: 2014/3/13
Profile: CWL, L50F [GB]			

Counterweight, fitting

Op nbr 716-002

1. Suspend the counterweight from a crane using suitable hoisting equipment and position it on the rear frame plate.

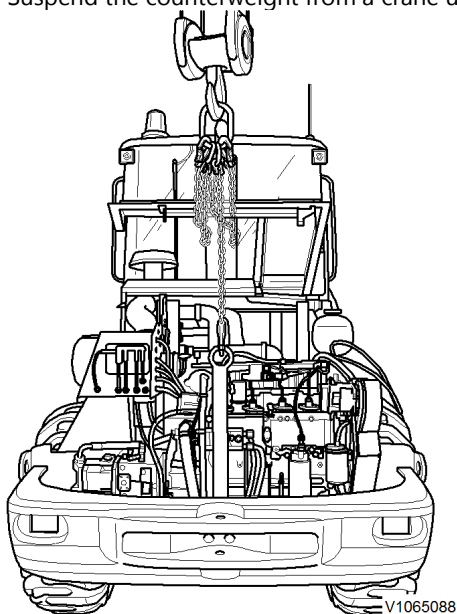

Figure 1

NOTE!

Counterweight, weight: approx. 600 kg (1322 lb).

2. Fit retaining bracket (1) right and left. Tighten nuts to torque **210 Nm (155 lbf ft)**.

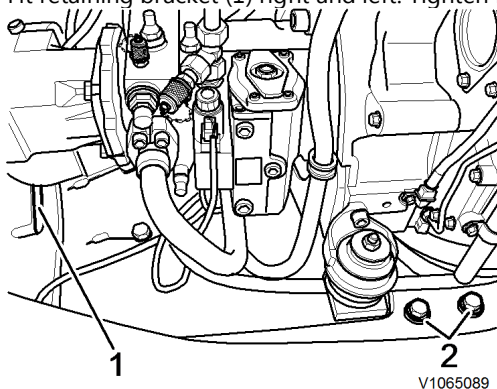

Figure 2

3. Fit the fixing bolts (2). Tighten nuts to **512 Nm (378 lbf ft)**.
4. Fit the engine hood catch (1) at the counterweight.

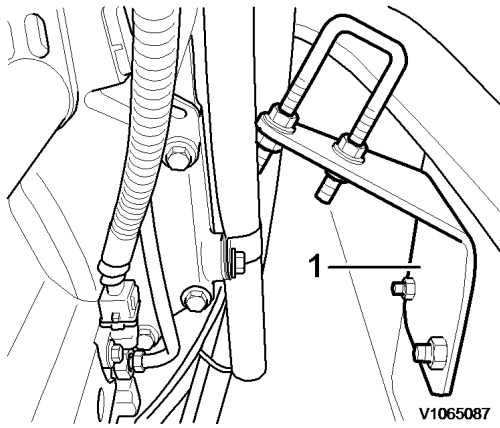

Figure 3

5. Connect the pin plug connection (1) of the tail lights.

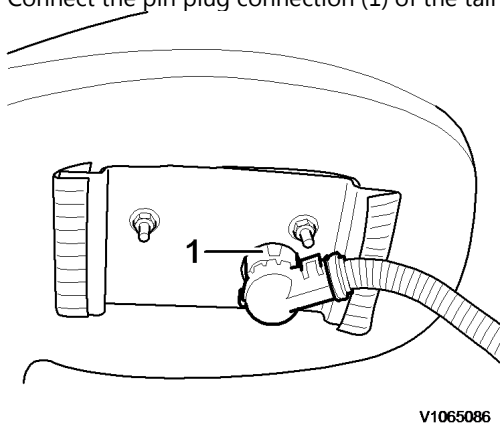

Figure 4

Document Title: Frame joint, separating machine	Function Group: 741	Information Type: Service Information	Date: 2014/3/13
Profile: CWL, L50F [GB]			

Frame joint, separating machine

Op nbr 741-001

[88830175 Pump](#)

[11666054 Jack](#)

WARNING

The work involves handling heavy components - failure to stay alert may result in severe crushing injuries.

1. Remove the bucket or attachment.
2. Place the machine in the service position and position the lifting bracket on a stand jack.

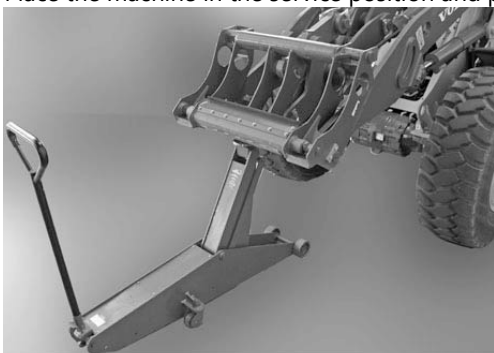

V1086960

Figure 1

3. Depressurise the hydraulic system and switch off the battery isolation switch.
4. Remove the right and left side panels (1).

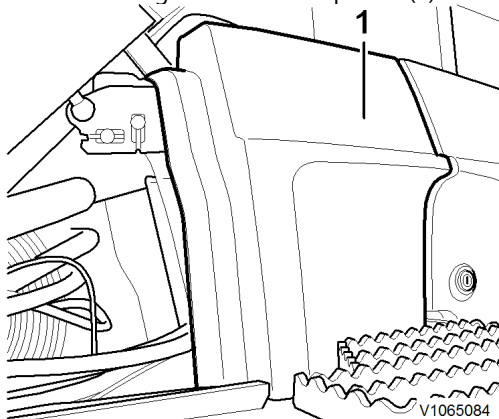

V1065084

Figure 2

5. Unscrew the cab fixing bolts and lock bolts.

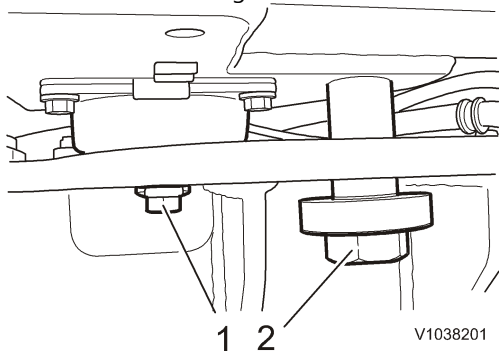

Figure 3

- 1. retaining screw
- 2. Lock screw

6. Unscrew the cab roof lock screws and screw in the lifting eyes (1). Hoist the cab with a crane hoist.

NOTE!

Use secure lifting equipment with sufficient capacity.

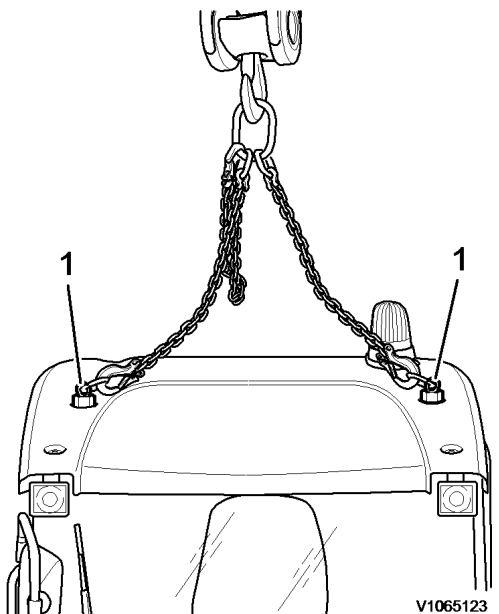

Figure 4

7. Slowly lift the cab and set it on the cab supports (1). [080 E-tool Cab support](#)

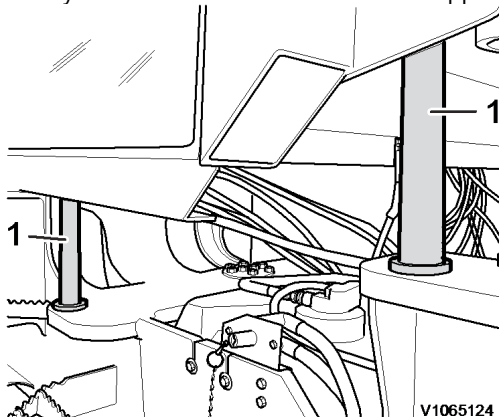

Figure 5

NOTE!

When raising the cab, make sure that no hoses or cables are ripped off. Detach if necessary.

8. Remove the retaining strap (1) from the line bundle and remove the holder (2).

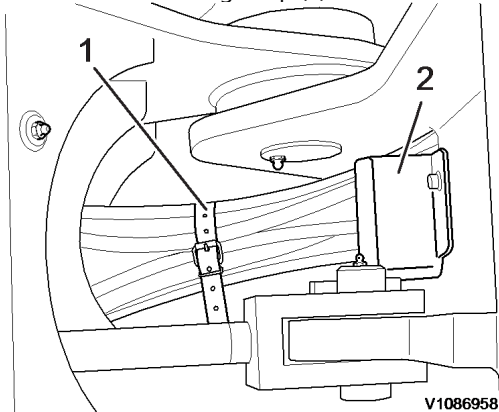

Figure 6

9. Disconnect the electrical connector (FA) on the right side of the cab wall. Remove all cable ties along the hose bundle and unplug the cable harness for the front frame.

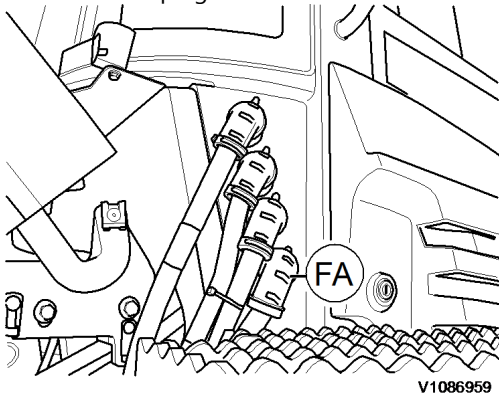

Figure 7

10. Open the service hatch (1) on the front frame.

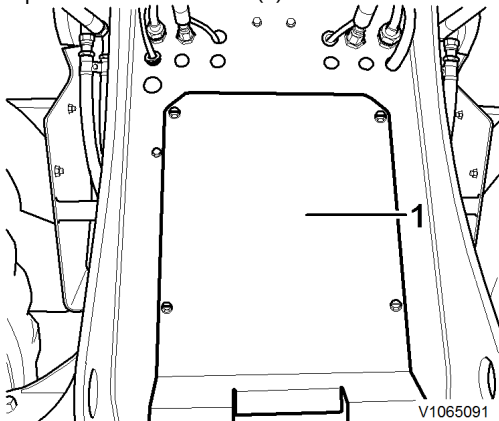

Figure 8

11. Disconnect the handbrake wire (1) and pull out of the front frame.

Thank you very much for reading.

This is part of the demo page.

GET MORE:

Hydraulic

System, Setting

Instructions, Functional

Description, Electrical

System And more.....

Click Here BUY NOW

Then Instant Download

the Complete Manual.